



YAMAHA

PARTS LIST

MODEL FS1G

(TYPE 468)

FOR W. GERMANY

MODEL FS1S

(TYPE 381)

FOR SWEDEN

YAMAHA MOTOR CO., LTD.

COPY RIGHT: ALL RIGHTS RESERVED

NO PART OF THIS PUBLICATION MAY BE REPRODUCED WITHOUT PERMIS.

FOREWORD

YAMAHA

PARTS LIST

MODEL FS1G

(TYPE 468)

FOR W. GERMANY

MODEL FS1S

(TYPE 381)

FOR SWEDEN

FOREWORD

This Parts List related to the parts in use for the YAMAHA FS1G FS1S. When you ordering replacement parts for the FS1G/FS1S, refer to this Parts List and write both part numbers and part names correctly.

1. Structure of Part No.

Yamaha parts are divided largely into two categories; general parts and standard parts, and each part No. has the following structure:

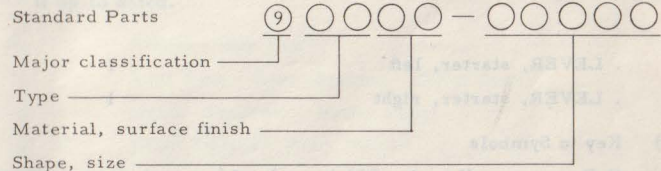
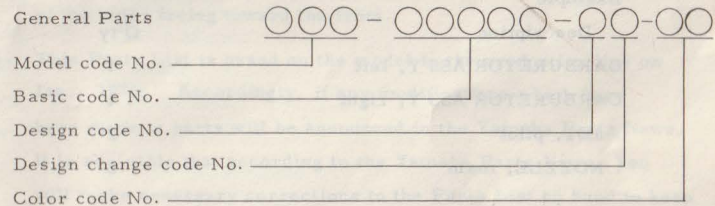

Note: Every standard No. begins with 9.

2. How to Use this Parts List

- (1) Except for steel balls (whose size is indicated in inches), the size of all parts is indicated in millimeters in the following manner.

Pipe (rubber or vinyl) Inside diameter - length

O-ring Section area - inside diameter

Washer, shim, collar Inside diameter - outside diameter - thickness (length)

- (2) Parts, which are to be supplied in the form of assemblies, are listed with an indentation of one letter's space, and a dot (.) is put

against the name of each part. If any two different assemblies (e. g., right and left side components) consist of almost the same type components, these two assemblies are listed in two lines, and then the names of component parts are listed in the subsequent lines with an indentation as mentioned earlier. The quantity of parts is given in the following manner; that is, in the case of parts being the same in type between the right and left, a total quantity of parts is given. On the other hand, if the right and left side parts are different in type, the quantity of part(s) on each side is given.

Example

Description	Q'ty
CARBURETOR ASS'Y, left	1
CARBURETOR ASS'Y, right	1
. JET, pilot	2
. NOZZLE, main	2
.	
.	
.	
. LEVER, starter, left	1
. LEVER, starter, right	1

(3) Key to Symbols

U.R.	Use size (thickness) and/or number as required
U.N.	Use as may as you need
T	Number of teeth in a gear
V	Voltage for light bulbs
S	"S" type oil seal or "S" type circlip
SD	"SD" type oil seal
SO	"SO" type oil seal
SW	"SW" type oil seal
E	"E" type circlip
R	"R" type circlip
F/No.	Frame No. (Applicable machine No.)

- (4) The parts marked with "X" in your country column are exclusive for your country, therefore, you should place an order only those parts. Meanwhile, the other parts are common for all European countries, and then we do not mention the names of countries.
- (5) The parts marked with * in the remark column of this list are not supplied with by Yamaha, those have to be found locally.
- (6) Please be advised that we supply you with Head Lamp Unit Ass'y and Tail Lamp Unit Ass'y without bulbs.
- (7) The right and left in relation to parts are determined on the basis of the rider facing toward the front.
- (8) This Parts List is based on the model in the production line on Jan., 1975. Accordingly, if any modifications which have been made to parts will be announced in the Yamaha Parts News. It is advisable that according to the Yamaha Parts News, You will make necessary corrections to the Parts List on hand to keep it up-to dated.

CONTENTS

ENGINE

Fig. 1	Crankcase • Cylinder	1
Fig. 2	Crankcase Cover	3
Fig. 3	Crank • Piston	5
Fig. 4	Clutch	9
Fig. 5	Transmission	11
Fig. 6	Shifter 1	15
Fig. 7	Shifter 2	17
Fig. 8	Kick Starter	19
Fig. 9	Intake	21
Fig. 10	Carburetor	23
Fig. 11	Exhaust	27
Fig. 12	Flywheel Magneto	29

CHASSIS

Fig. 13	Frame • Side Cover	33
Fig. 14	Rear Arm • Rear Cushion • Chain Case	35
Fig. 15	Stand • Footrest • Brake Pedal	39
Fig. 16	Front Fender • Rear Fender	41
Fig. 17	Front Fork	43
Fig. 18	Steering	47
Fig. 19	Handle • Wire	49
Fig. 20	Fuel Tank	53
Fig. 21	Seat	55
Fig. 22	Front Wheel	57
Fig. 23	Rear Wheel	61
Fig. 24	Head Lamp 1	67
Fig. 25	Head Lamp 2	69
Fig. 26	Speedometer	71

Fig. 27	Tail Lamp	73
Fig. 28	Flasher Lamp 1	75
Fig. 29	Flasher Lamp 2	77
Fig. 30	Electrical	79

NUMERICAL INDEX

1	74
2	74
3	74
4	74
5	74
6	74
7	74
8	74
9	74
10	74
11	74
12	74
13	74
14	74
15	74
16	74
17	74
18	74
19	74
20	74
21	74
22	74
23	74
24	74
25	74
26	74
27	74
28	74
29	74
30	74
31	74
32	74
33	74
34	74
35	74
36	74
37	74
38	74
39	74
40	74
41	74
42	74
43	74
44	74
45	74
46	74
47	74
48	74
49	74
50	74
51	74
52	74
53	74
54	74
55	74
56	74
57	74
58	74
59	74
60	74
61	74
62	74
63	74
64	74
65	74
66	74
67	74
68	74
69	74
70	74
71	74
72	74
73	74
74	74
75	74
76	74
77	74
78	74
79	74
80	74
81	74
82	74
83	74
84	74
85	74
86	74
87	74
88	74
89	74
90	74
91	74
92	74
93	74
94	74
95	74
96	74
97	74
98	74
99	74
100	74

ENGINE



Fig. 1 CRANKCASE · CYLINDER

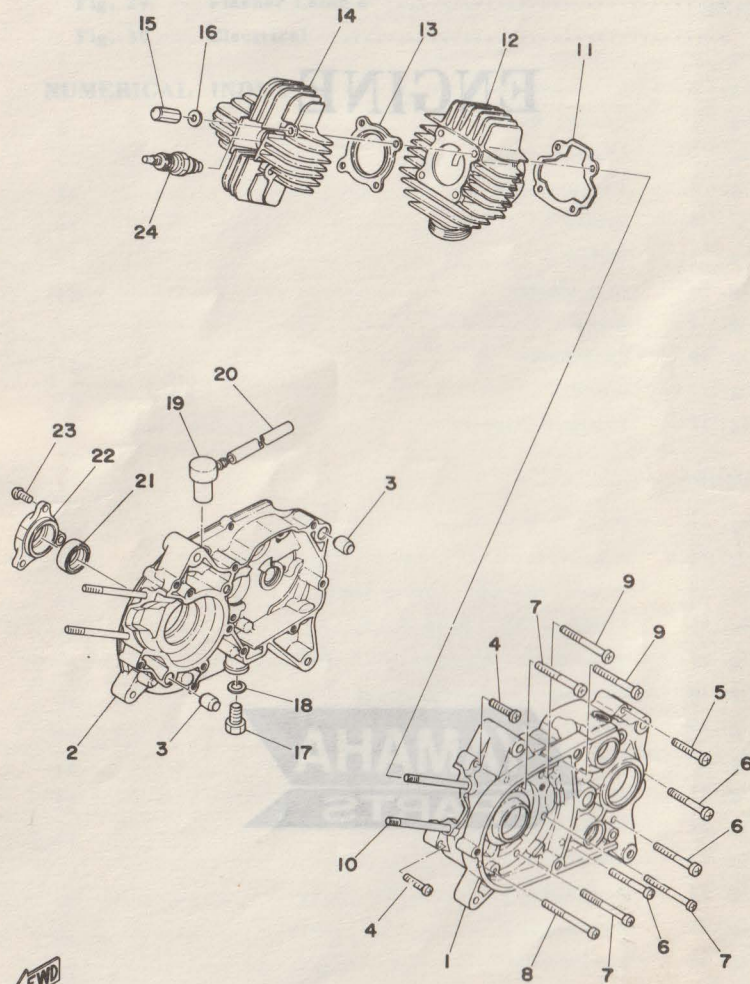

CRANKCASE · CYLINDER

Ref. No.	Parts No.	Description	Q'ty	ITALY	HOLLAND	AUSTRIA	NETHERLANDS	FINLAND	GERMANY	SWITZERLAND	FRANCE	Remarks
1- 1	257-15111-01	CASE, crank left	1	x								
1- 2	378-15121-60	CASE, crank right	1	x								
1- 3	91810-05016	PIN, dowel (8.4-12-16)...	2	x								
1- 4	92501-06030	SCREW, panhead	2	x								
1- 5	92501-06045	SCREW, panhead	1	x								
1- 6	92501-06050	SCREW, panhead	3	x								
1- 7	92501-06060	SCREW, panhead	3	x								
1- 8	92501-06065	SCREW, panhead	1	x								
1- 9	92501-06055	SCREW, panhead	2	x								
1-10	90116-06026	BOLT (109-11361-00)	4	x								
1-11	109-11351-00	GASKET, cylinder	1	x								
1-12	257-11311-00	CYLINDER	1	x								
	378-11311-60	CYLINDER	1					x				
1-13	107-11181-01	GASKET, cylinder head ..	1	x								
	381-11181-60	GASKET, cylinder head ..	1					x				
1-14	257-11111-01-94	HEAD, cylinder	1	x				x				
1-15	90176-06002	NUT (126-11171-60)	4	x				x				
1-16	92901-06200	WASHER, plain	4	x				x				
1-17	90340-12005	PLUG, drain (132-15351-00)	1	x				x				
1-18	90340-12038	GASKET, drain plug	1	x				x				
1-19	120-15371-00	BREATHER	1	x				x				
1-20	90446-07009	PIPE (304-15373-00 5-200)	1	x				x				
1-21	93103-25078	OIL SEAL (SW-25-35-10) ..	1	x				x				
1-22	378-15359-60	HOUSING, oil seal	1	x				x				
1-23	92501-06015	SCREW, panhead	3	x				x				
1-24	94701-00039	PLUG, spark (B-6HS)	1	x				x				



Fig. 2 CRANKCASE COVER

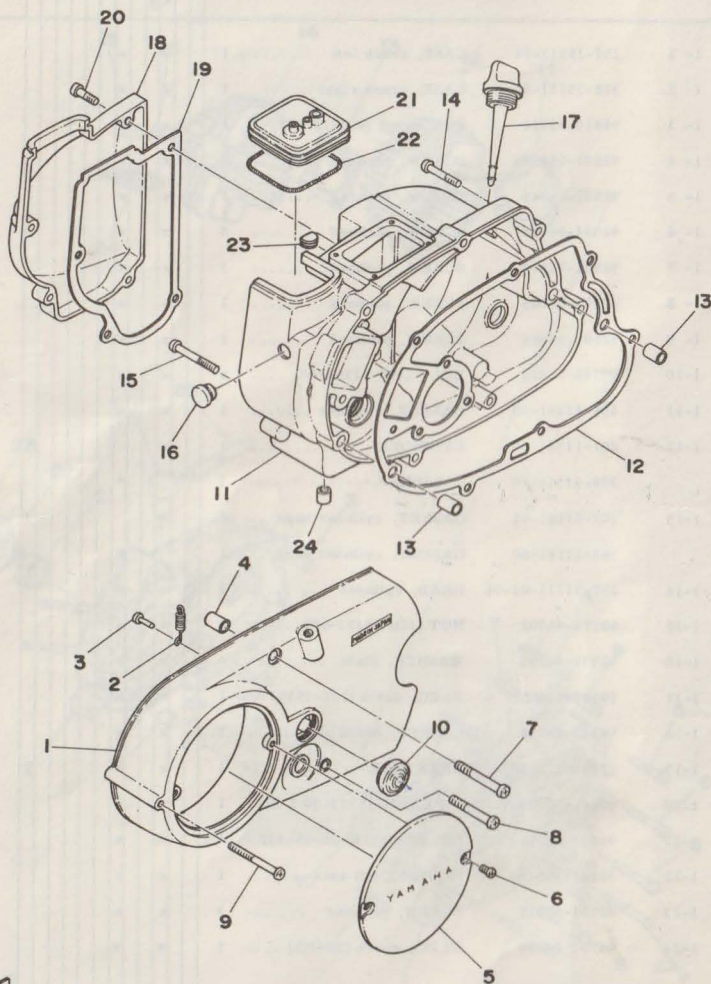

CRANKCASE COVER

Ref. No.	Parts No.	Description	Q'ty	FRANCE	HOLLAND	GERMANY	SWITZERLAND	SWEDEN	DENMARK	NORWAY	AUSTRIA	ENGLAND	ITALY	Remarks
2- 1	257-15410-01	CRANKCASE COVER ASS'Y, left	1	x				x						
2- 2	90506-07006	. SPRING, lever return	1	x				x						
2- 3	132-16346-00	. HOOK, spring	1	x				x						
2- 4	91810-02015	PIN, dowel (6.4-10-15)	2	x				x						
2- 5	164-15415-00	COVER, generator	1	x				x						
2- 6	98501-04006	SCREW, panhead	2	x				x						
2- 7	92501-06045	SCREW, panhead	2	x				x						
2- 8	92501-06040	SCREW, panhead	1	x				x						
2- 9	92501-06050	SCREW, panhead	1	x				x						
2-10	257-15417-01	COVER, cap	1	x				x						
2-11	378-15426-60	COVER, crankcase right	1	x										
	471-15420-60	CRANKCASE COVER ASS'Y, right	1											
2-12	378-15451-60	GASKET, crankcase cover	1	x				x						
2-13	91810-02015	PIN, dowel (6.4-10-15)	2	x				x						
2-14	92501-06030	SCREW, panhead	6	x				x						
2-15	92501-06040	SCREW, panhead	1	x				x						
2-16	90480-12012	GROMMET (122-15486-00)	1	x				x						
2-17	315-15362-01	PLUG, oil level	1	x				x						
2-18	257-15413-00	COVER, carburetor	1	x				x						
2-19	257-15463-00	GASKET, carburetor cover	1	x				x						
2-20	92501-06018	SCREW, panhead	4	x				x						
2-21	288-14481-01	CAP, carburetor	1	x				x						
2-22	90506-06095	BAND (288-14455-00)	1	x				x						
2-23	129-15489-10	GROMMET, pump wire	1	x				x						
2-24	257-15433-00	CLEANER, drain	1	x				x						

FWD

Fig. 3 CRANK · PISTON

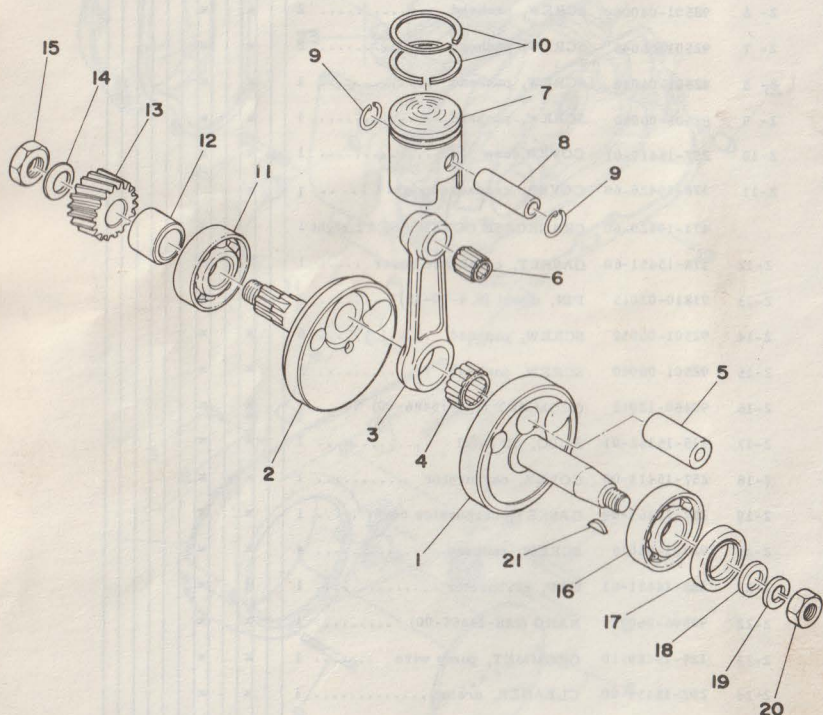

CRANK · PISTON

Ref. No.	Parts No.	Description	Q'ty	Applicable Machine No.	Remarks
3- 0-1	355-11400-00	CRANK ASS'Y	1		
3- 1	257-11412-01	. CRANK, left	1		
3- 2	257-11422-00	. CRANK, right	1		
3- 3	517-11651-00	. ROD, connecting	1		
3- 4	93310-41810	. BEARING, con-rod big end	1		
3- 5	257-11681-00	. PIN, crank	1		
3- 6	93310-11268	BEARING, con-rod small end	1		
3- 7	109-11631-02-96	PISTON (39.96mm STD)	1	} U. R	}
	109-11631-02-98	PISTON (39.98mm STD)	1		
	109-11635-02	PISTON (40.25mm 1st O.S)	1		Alternate Parts
	109-11636-02	PISTON (40.50mm 2nd O.S)	1		Alternate Parts
	109-11637-02	PISTON (40.75mm 3rd O.S)	1		Alternate Parts
	109-11638-02	PISTON (46.00mm 4th O.S)	1		Alternate Parts
3- 8	102-11633-01	PIN, piston	1		
3- 9	93450-13022	CLIP, piston pin	2		
3-10	260-11601-00	PISTON RING SET (STD)	1s		
	260-11601-10	PISTON RING SET (1st O.S)	1s		Alternate Parts
	260-11601-20	PISTON RING SET (2nd O.S)	1s		Alternate Parts
	260-11601-30	PISTON RING SET (3rd O.S)	1s		Alternate Parts
	260-11601-40	PISTON RING SET (4th O.S)	1s		Alternate Parts
3-11	93306-30302	BEARING (B6303)	1		
3-12	90387-17139	COLLAR (378-16136-60)	1		
3-13	257-16111-00	GEAR, primary drive (19T)	1		
3-14	90208-12015	SPRING (164-16119-00)	1		
3-15	90170-12060	NUT, lock (137-16377-00)	1		
3-16	93306-20414	BEARING (B6204C3)	1		
3-17	93102-20009	OIL SEAL (SD-20-35-7)	1		
3-18	90201-12178	WASHER (214-11557-01)	1		
3-19	92901-12100	WASHER, spring	1		

Fig. 3 CRANK · PISTON

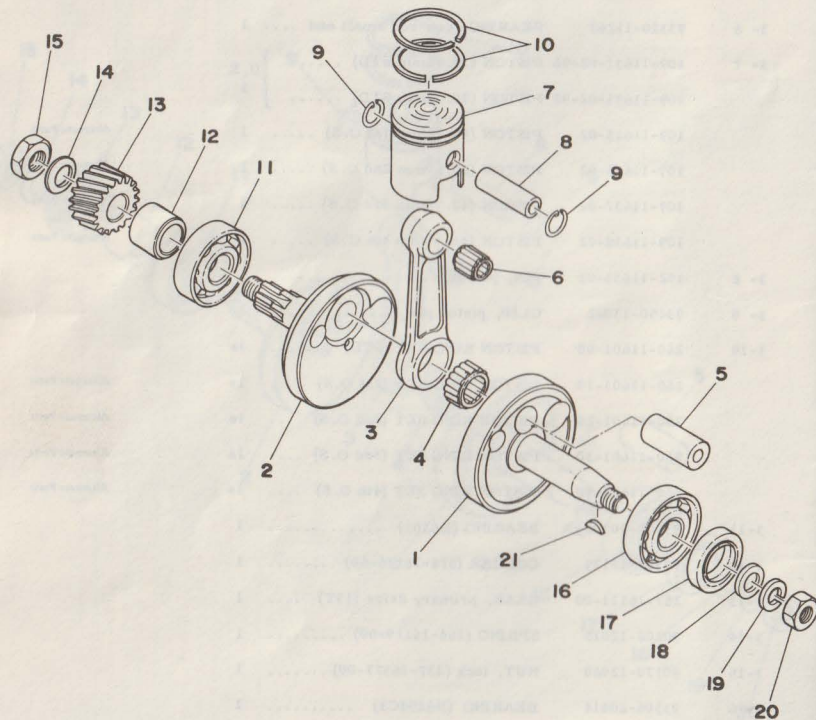

CRANK · PISTON

Ref. No.	Parts No.	Description	Q'ty	Applicable Machine No.	Remarks
3-20	90170-12175	NUT (98801-12200)	1		
3-21	90280-03017	KEY, woodruff (146-11545-00)	1		
ALTERNATE PARTS					
3-0-2	260-11630-00	PISTON ASS'Y (STD)	1	} Ref. No. 7, 8, 9, 10	
	260-11630-10	PISTON ASS'Y (1st O.S)	1		
	260-11630-20	PISTON ASS'Y (2nd O.S)	1		
	260-11630-30	PISTON ASS'Y (3rd O.S)	1		
	260-11630-40	PISTON ASS'Y (4th O.S)	1		

Fig. 4 CLUTCH

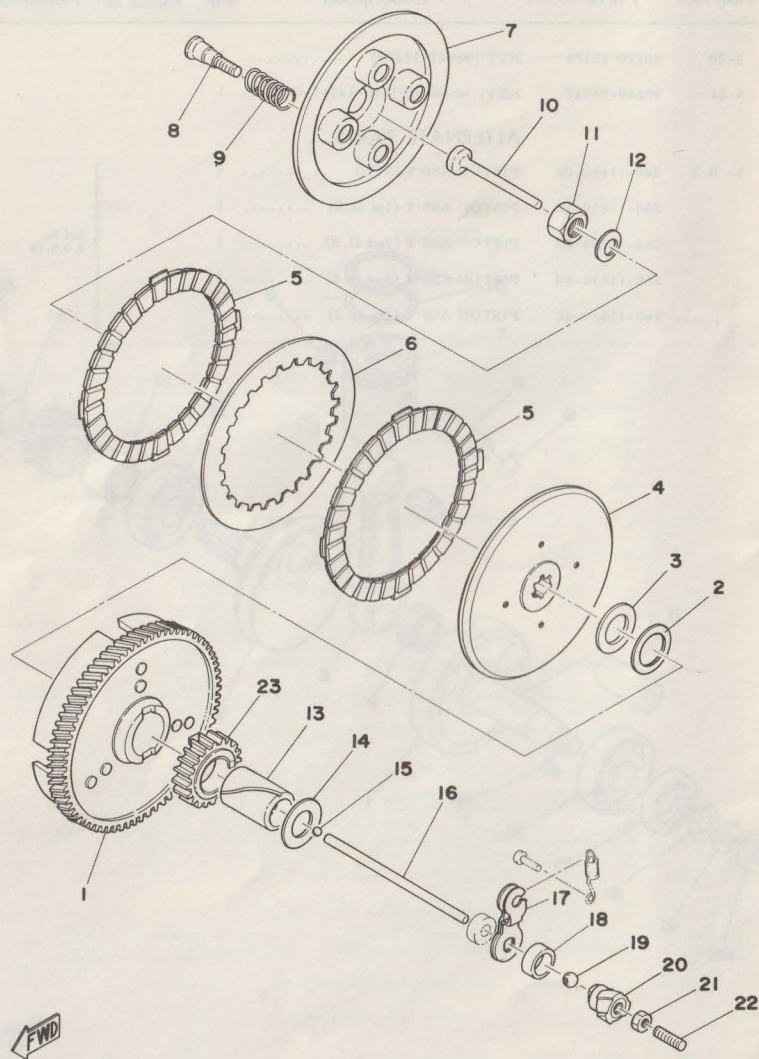

FWD

CLUTCH

Ref. No.	Parts No.	Description	Q'ty	Applicable Machine No.	Remarks
4- 0-1	257-16301-01	CLUTCH ASS'Y	1		
4- 1	257-16150-01	. PRIMARY DRIVEN GEAR COMP. (74T)	1		
4- 2	90201-23315	. WASHER (116-16153-00)	1		
4- 3	122-16164-00	. PLATE, thrust (17.2-30-2)	1		
4- 4	257-16371-00	. BOSS, clutch	1		
4- 5	131-16321-00	. PLATE, friction	2		
4- 6	257-16324-00	. PLATE, clutch	1		
4- 7	257-16351-00	. PLATE, pressure	1		
4- 8	90149-05057	. SCREW, spring (137-16337-01)	4		
4- 9	90501-20122	. SPRING, clutch (137-16333-00)	4		
4-10	137-16356-00	ROD, push 1	1		
4-11	90170-12060	NUT, clutch boss (137-16377-00)	1		
4-12	90208-12015	SPRING (164-16119-00)	1		
4-13	90560-17150	SPACER (257-16181-01)	1		
4-14	122-16164-00	PLATE, thrust (17.2-30-2)	1		
4-15	93503-16003	BALL (3/16 inch)	1		
4-16	257-16357-00	ROD, push 2	1		
4-17	257-16342-00	LEVER, push	1		
4-18	93108-15001	OIL SEAL (OSO-15.3-22-7)	1		
4-19	93501-04011	BALL (1/4 inch)	1		
4-20	257-16341-00	SCREW, push	1		
4-21	95301-06700	NUT	1		
4-22	90113-06009	SCREW (257-16343-00)	1		
4-23	254-15631-00	GEAR, kick pinion (18T)	1		

Fig. 5 TRANSMISSION

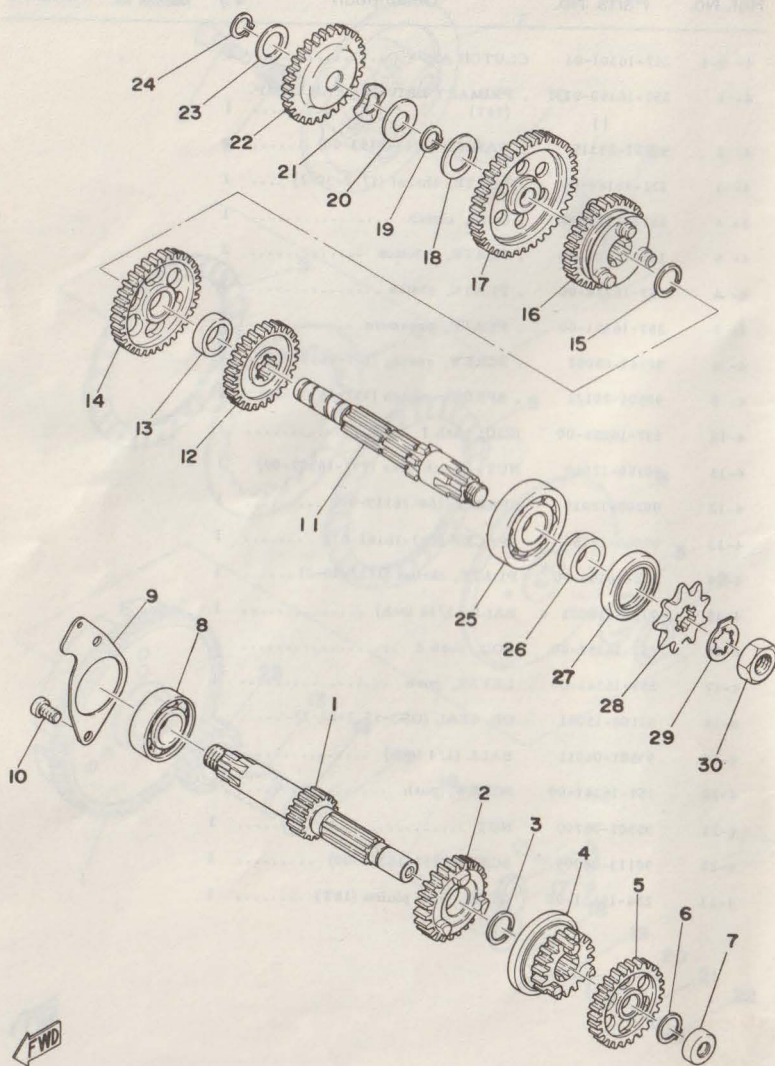

TRANSMISSION

Ref. No.	Parts No.	Description	Q'ty	FRANCE	HOLLAND	W. GERMANY	SWITZERLAND	BEIJING	SWEDEN	FRANCE	FINLAND	NETHERLANDS	ENGLAND	ITALY	REMARKS
5- 1	257-17411-01	AXLE, main (13T)	1	x					x						
5- 2	257-17131-01	GEAR, 3rd pinion (23T)	1	x					x						
5- 3	93440-16030	CLIP (257-17414-00)	1	x					x						
5- 4	257-17121-00	GEAR, 2nd pinion (18T)	1	x					x						
5- 5	257-17141-00	GEAR, 4th pinion (26T)	1	x					x						
5- 6	93410-13004	CIRCLIP (S-13)	1	x					x						
5- 7	257-15389-00	SEAL, push rod	1	x					x						
5- 8	93306-20303	BEARING (B6203Z)	1	x					x						
5- 9	257-17471-01	PLATE, bearing cover	1	x					x						
5-10	92501-06012	SCREW, panhead	2	x					x						
5-11	257-17421-01	AXLE, drive	1	x					x						
5-12	257-17241-00	GEAR, 4th wheel (27T)	1	x					x						
5-13	90387-16127	COLLAR (257-17258-00)	1	x					x						
5-14	257-17221-01	GEAR, 2nd wheel (34T)	1	x					x						
5-15	93440-16030	CLIP (257-17414-00)	1	x					x						
5-16	257-17231-00	GEAR, 3rd wheel (30T)	1	x					x						
5-17	257-17211-00	GEAR, 1st wheel (40T)	1	x					x						
5-18	257-17219-00	SHIM (13.2-24-0.6)	1	x					x						
5-19	93410-13004	CIRCLIP (S-13)	1	x					x						
5-20	132-15653-00-10	SHIM, thrust washer	1	x					U. R						
	132-15653-00-12	SHIM, thrust washer													
	132-15653-00-14	SHIM, thrust washer													
5-21	90206-15021	WASHER (137-15643-00)	1	x					x						
5-22	257-15651-01	GEAR, kick idle (26T)	1	x					x						
5-23	90201-13202	WASHER (201-15653-00)	1	x					x						
5-24	93410-13004	CIRCLIP (S-13)	1	x					x						

Fig. 5 TRANSMISSION

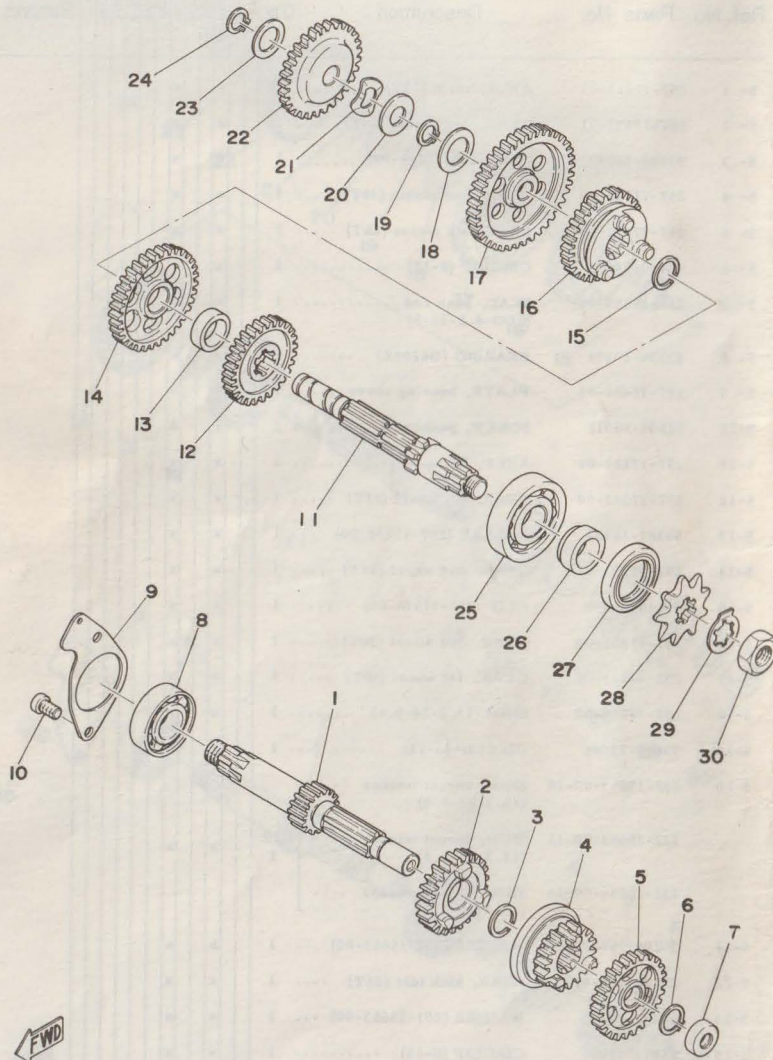

TRANSMISSION

Ref. No.	Parts No.	Description	Q'ty	ITALY	ENGLAND	AUSTRIA	NORWAY	DENMARK	FINLAND	SWEDEN	NETHERLANDS	FRANCE	REMARKS
5-25	93306-30305	BEARING (B6303)	1		x	x							
5-26	90387-17137	COLLAR (257-17462-00)	1		x								
	90387-17138	COLLAR (347-17462-00)	1					x					
5-27	93102-25017	OIL SEAL (SD-25-40-5)	1		x	x							
5-28	257-17461-10	SPROCKET, drive (11T) . .	1	U.R									
	257-17461-20	SPROCKET, drive (12T) . .											
	257-17461-30	SPROCKET, drive (13T) . .											
	347-17451-90	SPROCKET, drive (9T)	1					x					
5-29	90215-13019	WASHER (257-17464-00)	1		x								
	90215-13025	WASHER (347-17464-00)	1					x					
5-30	90179-12015	NUT, lock (257-17463-00) . . .	1		x								
	90179-12016	NUT, lock (347-17463-00) . . .	1						x				

Fig. 6 SHIFTER 1

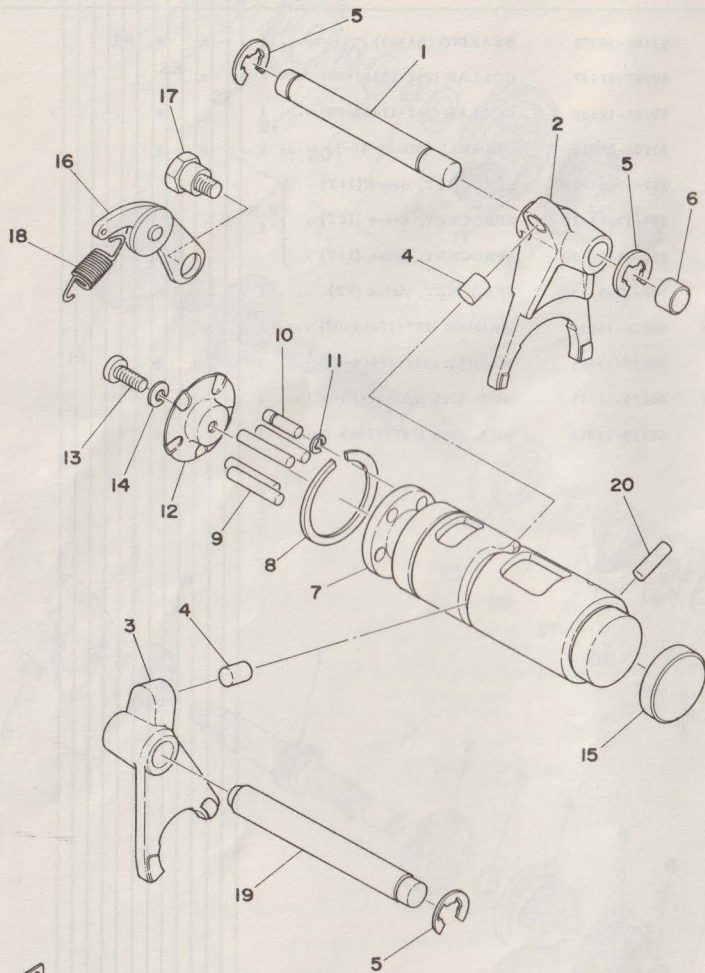

SHIFTER 1

Ref. No.	Parts No.	Description	Q'ty	Applicable Machine No.	Remarks
6- 1	257-18534-00	BAR, shift fork guide	1		
6- 2	259-18511-01	FORK, shift 1	1		
6- 3	257-18512-01	FORK, shift 2	1		
6- 4	90250-06013	PIN (257-18552-00)	2		
6- 5	93430-08006	CIRCLIP (E-8)	3		
6- 6	90334-10006	PLUG, blind (150-18328-00)	1		
6- 7	257-18541-61	CAM, shift	1		
6- 8	93440-32017	CIRCLIP (32 ϕ special)	1		
6- 9	93604-22050	PIN, dowel	4		
6-10	90249-04039	PIN, locating (174-18544-00)	1		
6-11	93430-03014	CIRCLIP (E-3)	1		
6-12	164-18561-00	PLATE, side	1		
6-13	98501-05012	SCREW, panhead	1		
6-14	92901-05100	WASHER, spring	1		
6-15	90338-26008	PLUG, blind (257-18589-00)	1		
6-16	132-18140-01	STOPPER LEVER ASS'Y	1		
6-17	90109-06001	BOLT, stopper (132-18177-00)	1		
6-18	90506-09112	SPRING, tension	1		
6-19	257-18531-00	BAR, shift fork guide	1		
6-20	93605-20043	PIN, dowel	1		

Fig. 7 SHIFTER 2

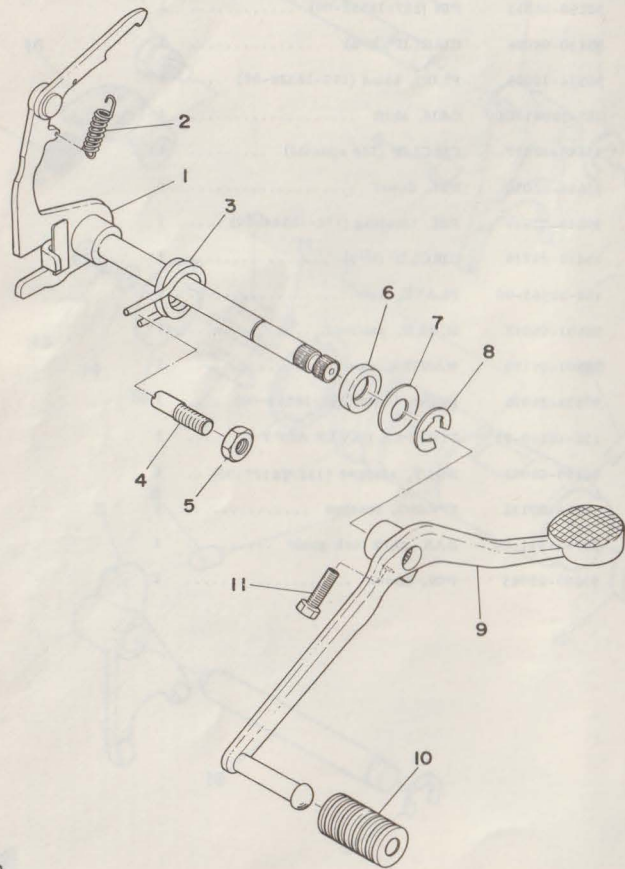

FWD

SHIFTER 2

Ref. No.	Parts No.	Description	Q'ty	Applicable Machine No.	Remarks
7- 1	257-18101-01	CHANGE SHAFT ASS'Y	1		
7- 2	90506-09009	. SPRING (132-18123-00)	1		
7- 3	90508-32207	SPRING (132-18124-00)	1		
7- 4	90149-08094	SCREW	1		
7- 5	95301-08600	NUT, hexagon	1		
7- 6	93101-12004	OIL SEAL (S-12-22-5)	1		
7- 7	90201-12183	WASHER (132-18137-00)	1		
7- 8	93430-10016	CIRCLIP (E-10)	1		
7- 9	257-18111-00-91	PEDAL, change	1		
7-10	132-18113-01	COVER, change pedal	1		
7-11	97321-06020	BOLT	1		

Fig. 8 KICK STARTER

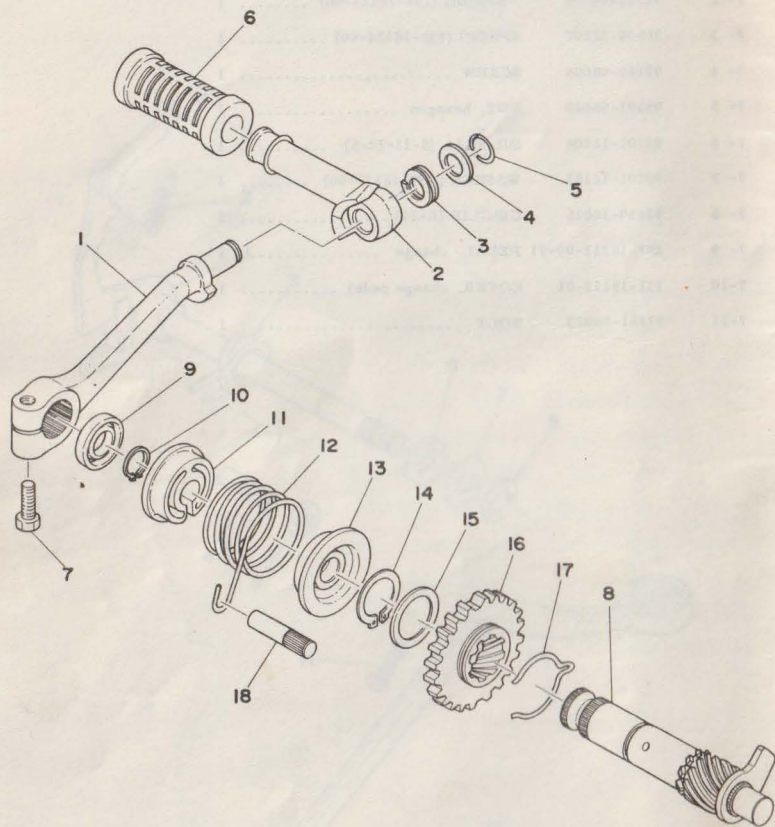

KICK STARTER

Ref. No.	Parts No.	Description	Q'ty	Applicable Machine No.	Remarks
8- 0-1	257-15610-02-91	KICK CRANK ASS'Y	1		
8- 1	257-15611-01	. CRANK, kick	1		Not for sale
8- 2	122-15612-02	. LEVER, kick	1		
8- 3	90504-18005	. SPRING (132-15625-01)	1		
8- 4	90209-10108	. WASHER (132-15616-01)	1		
8- 5	93440-10028	. CLIP (132-15617-00)	1		
8- 6	156-15618-01	COVER, kick lever	1		
8- 7	97311-06025	BOLT	1		
8- 8	305-15660-02	KICK AXLE ASS'Y	1		
8- 9	93109-15001	OIL SEAL (SDO-15-26-6)	1		
8-10	93410-15005	CIRCLIP (S-15)	1		
8-11	132-15676-00	COVER, kick spring	1		
8-12	90508-26136	SPRING, kick (304-15665-00)	1		
8-13	132-15664-00	GUIDE, kick spring	1		
8-14	93410-25017	CIRCLIP (S-25)	1		
8-15	117-15644-00	SHIM (25.1-32-1)	1		
8-16	305-15641-00	GEAR, kick (26T)	1		
8-17	90468-26048	CLIP, kick (315-15687-00)	1		
8-18	257-15668-00	STOPPER, kick spring	1		

Fig. 9 INTAKE

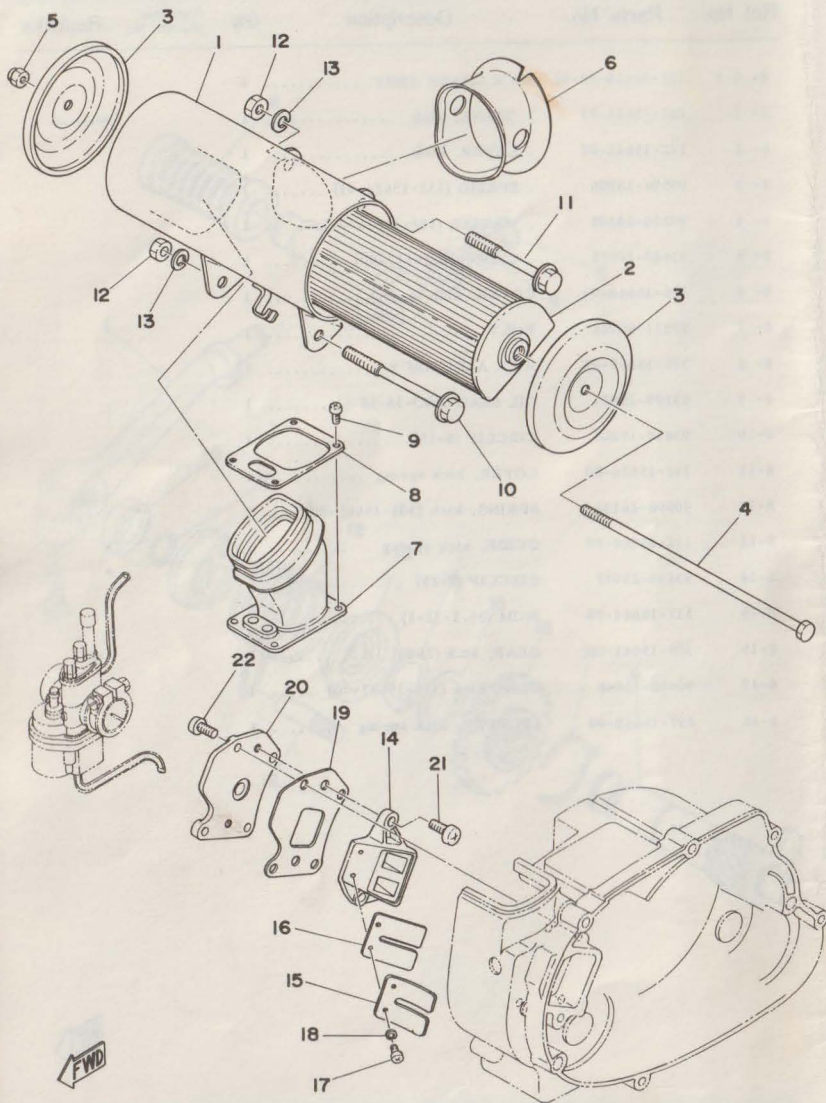

INTAKE

Ref. No.	Parts No.	Description	Q'ty	FRANCE	HOLLAND	GERMANY	SWITZERLAND	NETHERLANDS	BEELGIUM	SWEDEN	FINLAND	DENMARK	NORWAY	SPAIN	ITALY	REMARKS
9- 1	257-14401-00-35	AIR CLEANER CASE ASS'Y	1	x												Silver
9- 2	257-14451-00	ELEMENT, air cleaner	1	x												
9- 3	122-14412-00	CAP, cleaner case	2	x												
9- 4	97301-06187	BOLT	1	x												
9- 5	95303-06800	NUT, crown	1	x												
9- 6	257-14454-00	JOINT, suction pipe	1	x												
9- 7	283-14453-00	JOINT, air cleaner	1	x												
9- 8	257-14417-00	COVER, joint	1	x												
9- 9	98501-04008	SCREW, panhead	4	x												
9-10	95821-08100	BOLT, flange	1	x												
9-11	95821-08080	BOLT, flange	1	x												
9-12	95701-08100	NUT, flange	2	x												
9-13	92901-08100	WASHER, spring	2	x												
9-14	378-13610-61	REED VALVE ASS'Y	1	x												
9-15	314-13616-01	STOPPER, reed valve	1	x												
9-16	314-13613-00	VALVE, reed	1	x												
9-17	98512-03008	SCREW, panhead	2	x												
9-18	92901-03100	WASHER, spring	2	x												
9-19	378-13621-60	PACKING	1	x												
9-20	470-13555-60	JOINT	1	x												
9-21	92501-06015	SCREW, panhead	2	x												
9-22	92501-06015	SCREW, panhead	4													

Fig. 10 CARBURETOR

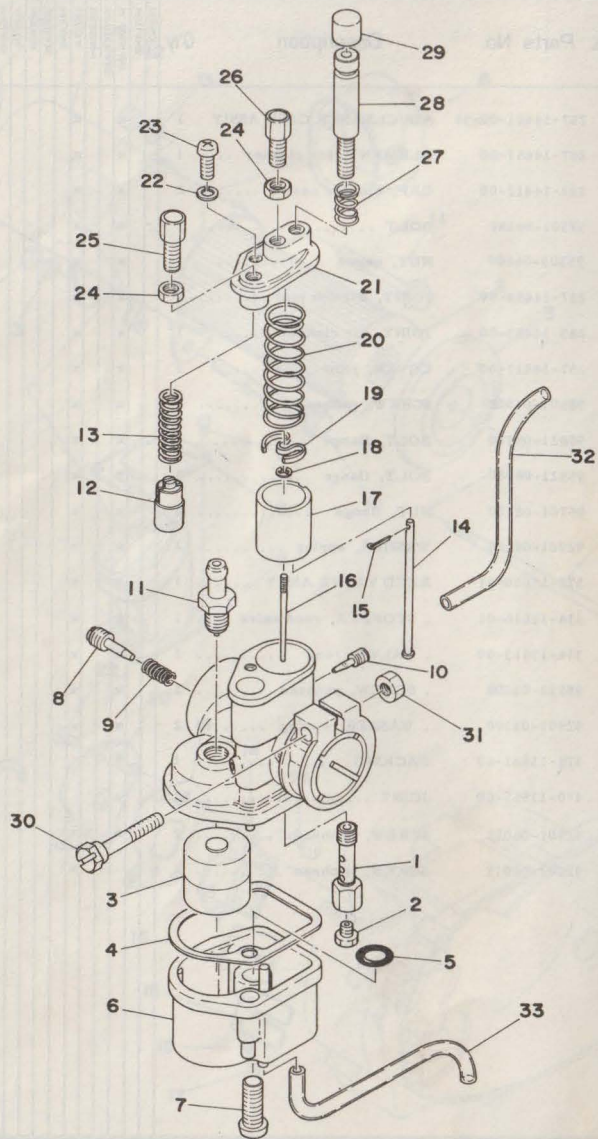

CARBURETOR

Ref. No.	Parts No.	Description	Q'ty	FRANCE	HOLLAND	SWITZERLAND	W. GERMANY	BELGIUM	SWEDEN	FINLAND	GERMANY	NORWAY	AUSTRIA	ENGLAND	ITALY	Remarks
10- 0-1	470-14101-00	CARBURETOR ASS'Y	1	x												
	471-14101-00	CARBURETOR ASS'Y	1								x					
10- 1	127-14141-10	. NOZZLE, main (E-0)	1	x												
	127-14141-14	. NOZZLE, main (E-4)	1								x					
10- 2	127-14143-20	. JET, main (#100)	1	U. R. 1	x											STD
	127-14143-21	. JET, main (#105)														
	127-14143-22	. JET, main (#110)														
	127-14143-30	. JET, main (#150)														
	127-14143-32	. JET, main (#160)														
	127-14143-34	. JET, main (#170)														
10- 3	260-14185-00	. FLOAT	1	x	x											
10- 4	260-14184-00	. GASKET, float chamber	1	x	x											
10- 5	93220-08002	. O-RING	1	x	x											
10- 6	260-14181-00	. BODY, float chamber	1	x	x											
10- 7	92501-06018	. SCREW, panhead	1	x	x											
10- 8	127-14123-00	. SCREW, air adjusting	1	x	x											
10- 9	127-14134-00	. SPRING, air adjusting	1	x	x											
10-10	260-14142-25	. JET, pilot (#25)	1	x	x											
10-11	260-14190-12	. VALVE SEAT ASS'Y (#1.2)	1	x	x											
10-12	127-14171-00	. PLUNGER, starter	1	x	x											
10-13	127-14135-00	. SPRING, plunger	1	x	x											
10-14	260-14114-00	. BAR, throttle	1	x												
	283-14114-00	. BAR, throttle														
10-15	91401-12010	. PIN, cotter	1	x	x											
	118-14116-02	. NEEDLE (3J2-3)														
10-16	348-14116-03	. NEEDLE (3F3-4)	1	x	x											
	257-14112-10	. VALVE, throttle (#1.0)														
10-17	283-14112-25	. VALVE, throttle (#2.5)	1	x												

Fig. 10 CARBURETOR

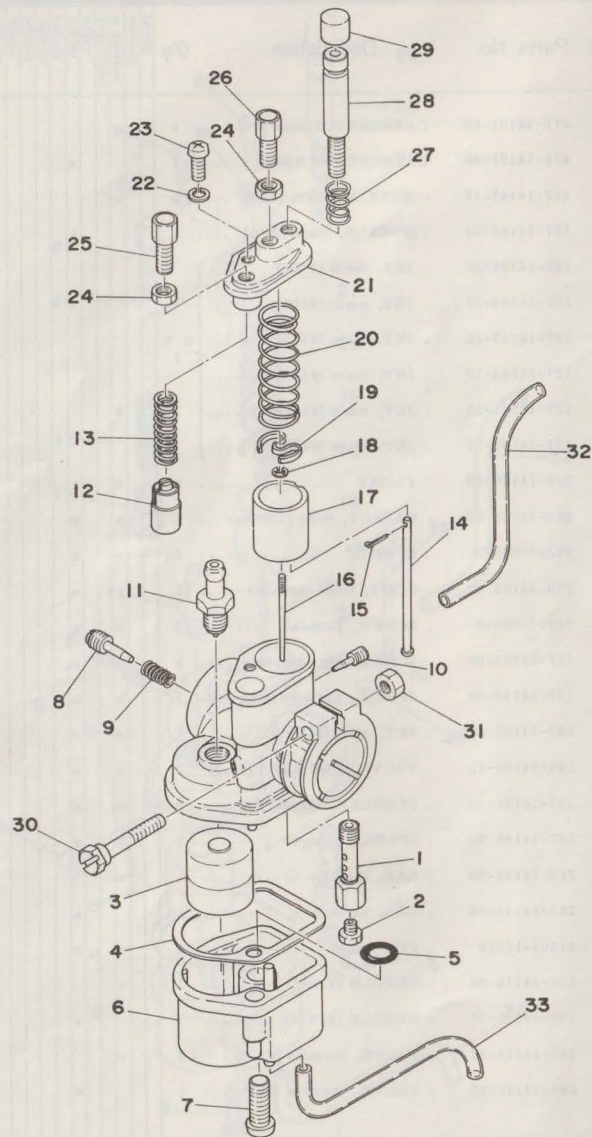

CARBURETOR

Ref. No.	Parts No.	Description	Q'ty	Country											Remarks
				FRANCE	HOLLAND	GERMANY	SWITZERLAND	BELGIUM	DENMARK	NORWAY	AUSTRIA	ENGLAND	ITALY		
10-18	127-14137-00	. CLIP	1	x								x			
10-19	296-14136-00	. SEAT, spring	1									x		x	
10-20	260-14131-00	. SPRING, throttle valve	1									x		x	
10-21	260-14158-01	. TOP, mixing chamber	1									x		x	
10-22	92901-04100	. WASHER, spring	1									x		x	
10-23	98501-04010	. SCREW, panhead	1									x		x	
10-24	127-14161-00	. NUT, wire adjusting	2									x		x	
10-25	127-14124-20	. SCREW, wire adjusting	1									x		x	
10-26	127-14124-20	. SCREW, wire adjusting	1									x			
10-27	127-14124-23	. SCREW, wire adjusting	1											x	
	137-14133-00	. SPRING, throttle stop	1									x			
10-28	127-14133-00	. SPRING, throttle stop	1											x	
	167-14121-00	. SCREW, throttle	1									x		x	
10-29	167-14119-00	. CAP, throttle screw	1									x		x	
10-30	127-14125-00	. SCREW, body fitting	1									x		x	
10-31	95301-05600	. NUT	1									x		x	
10-32	90445-05015	PIPE (257-14197-00 2.5-200)	1									x		x	
10-33	90445-05013	PIPE (137-14197-00 2.5-150)	1									x		x	

Fig. 11 EXHAUST

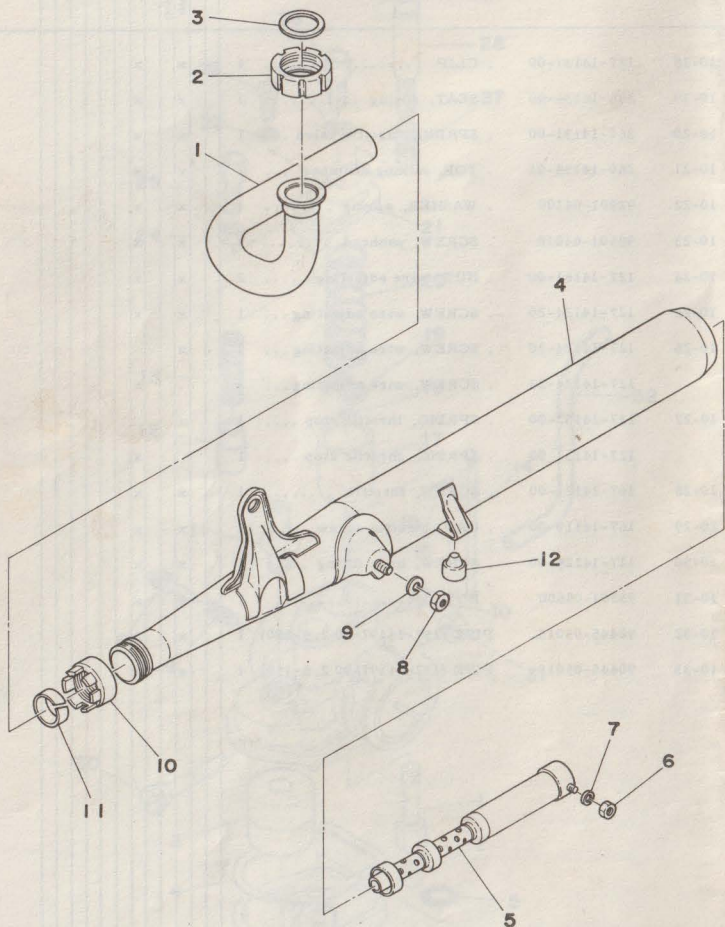

FWD

EXHAUST

Ref. No.	Parts No.	Description	Q'ty	COUNTRY												Remarks		
				FRANCE	HOLLAND	GERMANY	WEST GERMANY	SWITZERLAND	BELGIUM	SWEDEN	FINLAND	NETHERLANDS	AUSTRIA	ITALY	ENGLAND			
11- 1	348-14611-00	PIPE, exhaust	1	x									x					
11- 2	122-14612-02	NUT, ring	1	x									x					
11- 3	132-14613-00	GASKET, exhaust	1	x									x					
11- 4	378-14710-20	MUFFLER ASS'Y	1	x									x					
	381-14710-00	MUFFLER ASS'Y	1											x				
11- 5	296-14753-02	SILENCER	1	x														
	348-14753-00	SILENCER	1															
11- 6	95301-05600	NUT	1	x									x					
11- 7	92901-05100	WASHER, spring	1	x									x					
11- 8	95301-08600	NUT	1	x									x					
11- 9	92901-08100	WASHER, spring	1	x									x					
11-10	109-14713-00	NUT, muffler joint	1	x									x					
11-11	109-14714-02	GASKET, muffler joint	1	x									x					
11-12	102-27114-00	STOPPER, main stand	1	x									x					

Fig. 12 FLYWHEEL MAGNETO

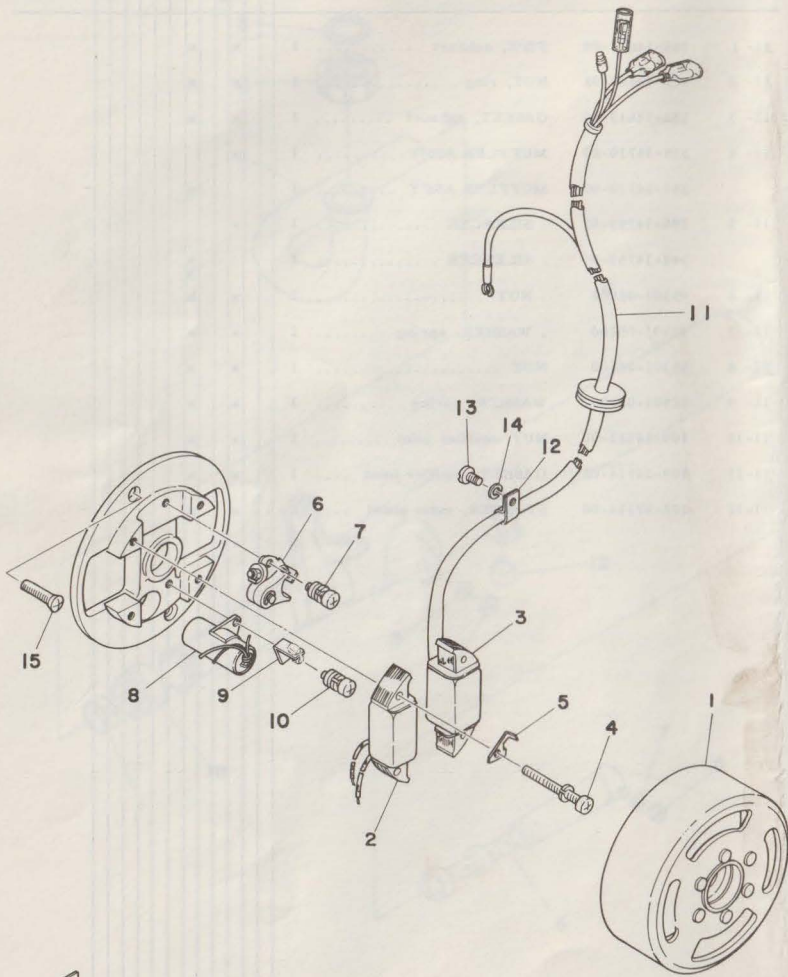

FWD

FLYWHEEL MAGNETO

Ref. No.	Parts No.	Description	Q'ty	FRANCE	HOLLAND	SWITZERLAND W. GERMANY	BELGIUM	SWEDEN	DENMARK	NORWAY	AUSTRIA	ITALY	Remarks
12- 0-1	257-81300-22	FLYWHEEL MAGNETO ASS'Y	1	x									
	381-81300-20	FLYWHEEL MAGNETO ASS'Y	1				x						
12- 1	257-81350-22	. ROTOR ASS'Y	1	x									
	381-81350-20	. ROTOR ASS'Y	1				x						
12- 2	207-81312-20	. COIL, source	1	x	x								
12- 3	207-81313-21	. COIL, lighting	1	x									
	381-81313-20	. COIL, lighting	1				x						
12- 4	110-81348-21	. SCREW, panhead (4-25)	4	x	x								
12- 5	353-81332-20	. PLATE, timing	1	x									
	166-81332-20	. PLATE, timing	1				x						
12- 6	437-81321-20	. CONTACT BREAKER ASS'Y	1	x									
	120-81321-20	. CONTACT BREAKER ASS'Y	1				x						
12- 7	110-81346-21	. SCREW, panhead (4-12)	1	x	x								
12- 8	296-81325-20	. CONDENSER	1	x	x								
12- 9	116-81331-20	. LUBRICATOR	1	x									
	120-81331-20	. LUBRICATOR	1				x						
12-10	110-81346-21	. SCREW, panhead (4-10)	1	x	x								
12-11	207-81315-20	. WIRE, lead	1	x									
	381-81315-20	. WIRE, lead	1				x						
12-12	104-81328-20	. CLAMP, lead	1	x	x								
12-13	164-81246-21	. SCREW, panhead (4-8)	1	x	x								
12-14	92901-04100	. WASHER, spring	1	x	x								
12-15	98701-05015	SCREW, flathead	2	x	x								

CHASSIS



Fig.13 FRAME · SIDE COVER

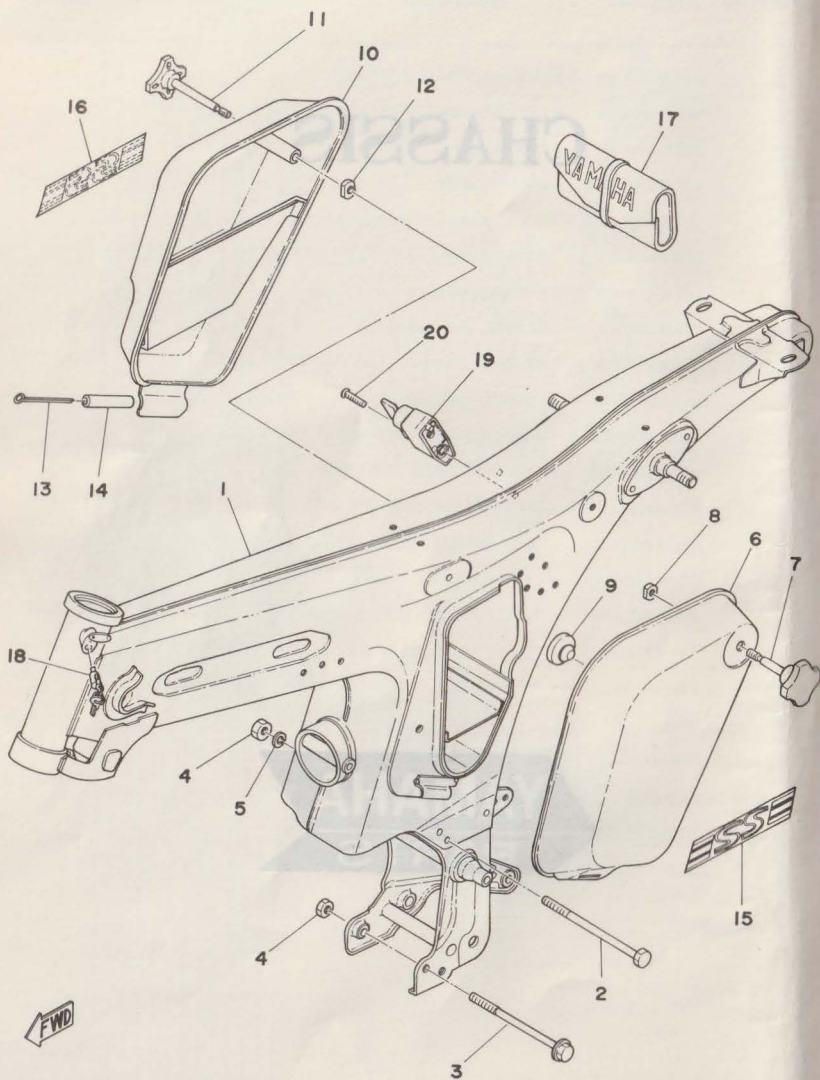

FRAME · SIDE COVER

Ref. No.	Parts No.	Description	Q'ty	FRANCE	HOLLAND	SWITZERLAND	W. GERMANY	BEIJING	SWEDEN	FINLAND	DENMARK	NETHERLANDS	ENGLAND	ITALY	Remarks
13-1	468-21110-40-33	FRAME COMP.	1	x											Yamaha Black
	471-21110-00-33	FRAME COMP.	1						x						Yamaha Black
13-2	90105-08025	BOLT, hexagon	1	x				x	x						
13-3	95821-08120	BOLT, flang	1	x				x	x						
13-4	95701-08100	NUT, flang	2	x				x	x						
13-5	92901-08100	WASHER, spring	1	x				x	x						
13-6	467-21711-00-G6	COVER, side left	1	x				x	x						Balboa Blue
	467-21711-00-K7	COVER, side left	1	x				x	x						Ive Green
	467-21711-00-M3	COVER, side left	1	x				x	x						Baja Brown
	467-21711-00-16	COVER, side left	1	x				x	x						Metallic Cosmic Blue
	467-21711-00-26	COVER, side left	1	x				x	x						Competition Yellow
13-7	122-21724-00	KNOB, side cover right	1	x				x	x						
13-8	90179-06034	NUT (136-21713-00)	1	x				x	x						
13-9	141-21717-00	DAMPER, side cover	1	x				x	x						
13-10	394-21721-00-G6	COVER, side right	1	x				x	x						Balboa Blue
	394-21721-00-K7	COVER, side right	1	x				x	x						Ive Green
	394-21721-00-M3	COVER, side right	1	x				x	x						Baja Brown
	394-21721-00-16	COVER, side right	1	x				x	x						Metallic Cosmic Blue
	394-21721-00-26	COVER, side right	1	x				x	x						Competition Yellow
13-11	209-21724-00	KNOB, side cover right ...	1	x				x	x						
13-12	90179-06036	NUT (136-21713-00)	1	x				x	x						
13-13	91401-50075	PIN, cotter	1	x				x	x						
13-14	283-21717-00	DAMPER, side cover	1	x				x	x						
13-15	467-21786-00	EMBLEM	1	x				x	x						
13-16	467-21787-00	EMBLEM	1	x				x	x						
13-17	260-28100-10	TOOL ASS'Y	1	x				x	x						
13-18	169-23480-10	STEERING LOCK ASS'Y ...	1	x				x	x						*
13-19	467-21308-00	HANGER, helmet	1	x				x	x						
13-20	92901-06030	SCREW, flathead	1	x				x	x						

Fig. 14 REAR ARM · REAR CUSHION · CHAIN CASE

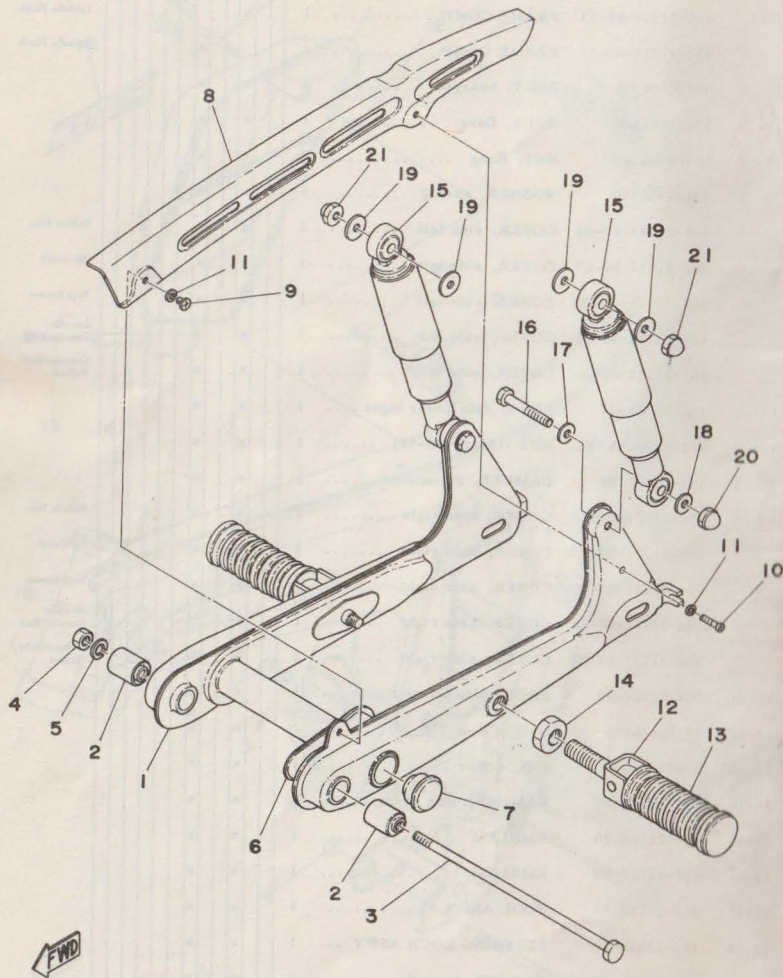

REAR ARM · REAR CUSHION · CHAIN CASE

Ref. No.	Parts No.	Description	Q'ty	FRANCE	HOLLAND	WEST GERMANY	SWITZERLAND	FINLAND	DENMARK	NORWAY	AUSTRIA	ENGLAND	ITALY	Remarks
14- 1	474-22110-00-33	REAR ARM COMP.	1	x										Yamaha Black
	220-22110-00-33	REAR ARM COMP.	1						x					Yamaha Black
14- 2	102-22123-00	BUSHING, rear arm	2	x					x					
14- 3	109-22141-00	SHAFT, pivot	1	x					x					
14- 4	95301-10600	NUT, hexagon	1	x					x					
14- 5	92901-10100	WASHER, spring	1	x										
14- 6	122-22151-00	SEAL, guard	1	x					x					
14- 7	180-22117-00	CAP, rear arm	1	x					x					
14- 8	468-22311-40-35	CHAIN CASE, half	1	x										Silver
	260-22311-00-35	CHAIN CASE, half	1						x					Silver
14- 9	98501-05008	SCREW, panhead	1	x					x					
14-10	98501-05020	SCREW, panhead	1	x					x					
14-11	92901-05100	WASHER, spring	2	x					x					
14-12	120-27430-02	REAR FOOTREST ASS'Y ...	2	x										
14-13	120-27433-00	. COVER, rear footrest ...	2	x										
14-14	95301-12700	NUT, hexagon	2	x										
14-15	468-22210-41-G6	REAR CUSHION ASS'Y	2	x										Balboa Blue
	468-22210-41-K7	REAR CUSHION ASS'Y	2	x										Ive Green
	468-22210-41-M3	REAR CUSHION ASS'Y	2	x										Baja Brown
	468-22210-41-16	REAR CUSHION ASS'Y	2	x										Metallic Cosmic Blue
	468-22210-41-26	REAR CUSHION ASS'Y	2	x										Competition Yellow
	467-22210-40-G6	REAR CUSHION ASS'Y	2							x				Balboa Blue
	467-22210-40-K7	REAR CUSHION ASS'Y	2							x				Ive Green
	467-22210-40-M3	REAR CUSHION ASS'Y	2							x				Baja Brown
	467-22210-40-16	REAR CUSHION ASS'Y	2							x				Metallic Cosmic Blue
	467-22210-40-26	REAR CUSHION ASS'Y	2							x				Competition Yellow
14-16	90101-12090	BOLT (220-22242-00)	2											
	90101-10255	BOLT	2	x										

Fig. 14 REAR ARM · REAR CUSHION · CHAIN CASE

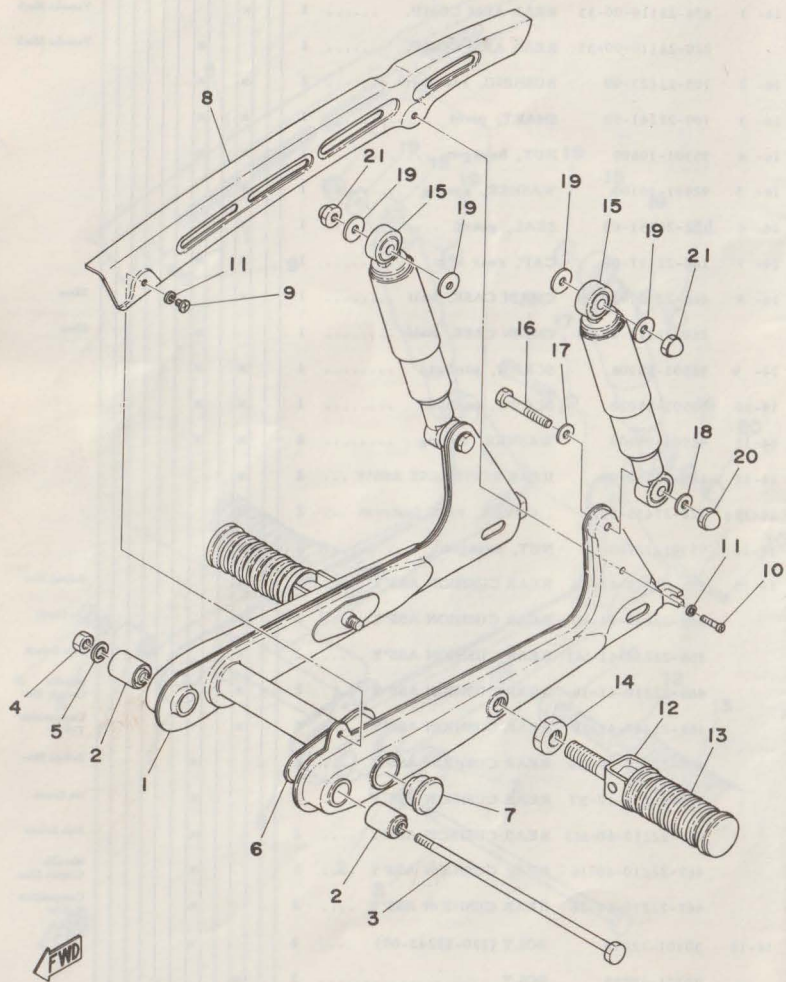

REAR ARM · REAR CUSHION · CHAIN CASE

Ref. No.	Parts No.	Description	Q'ty	FRANCE	HOLLAND	GERMANY	SWITZERLAND	BELGIUM	FINLAND	DENMARK	NORWAY	AUSTRIA	ENGLAND	ITALY	Remarks
14-17	90201-12175	WASHER (122-22244-00) ..	2							x					
	92901-10200	WASHER, plain	2	x											
14-18	90201-12190	WASHER (122-22243-00) ..	2						x						
14-19	90201-10140	WASHER (102-22243-00) ..	4						x						
	90201-10140	WASHER (102-22243-00) ..	6		x										
14-20	95304-12800	NUT, crown	2						x						
14-21	90176-10013	NUT, cap	2						x						
	90176-10013	NUT, cap	4		x										

Fig. 15 STAND · FOOTREST · BRAKE PEDAL

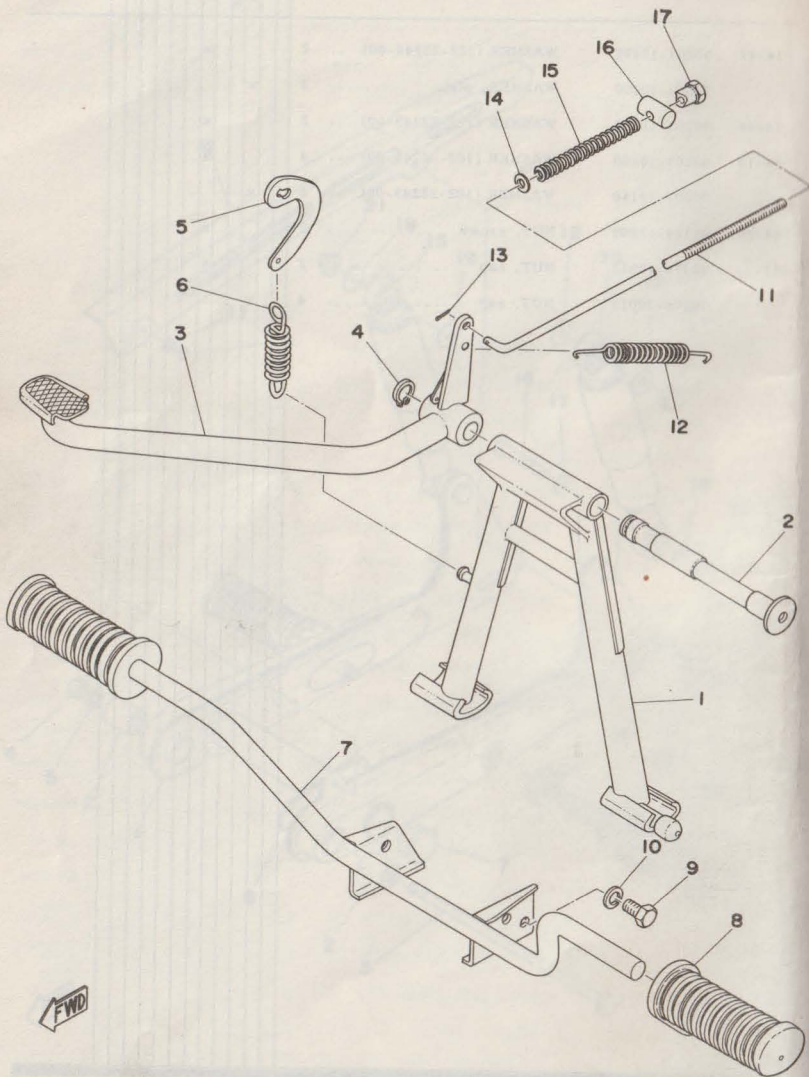

STAND · FOOTREST · BRAKE PEDAL

Ref. No.	Parts No.	Description	Q'ty												Remarks			
				FRANCE	HOLLAND	SWITZERLAND	WEST GERMANY	BELGIUM	FINLAND	DENMARK	NORWAY	AUSTRIA	ENGLAND	ITALY				
15- 1	207-27111-00	STAND, main	1	x								x						
15- 2	122-27112-00	SHAFT, main stand	1	x								x						
15- 3	257-27211-00	PEDAL, brake	1			x						x						
15- 4	93430-12008	CIRCLIP (E-12)	1			x						x						
15- 5	109-27115-00	LINK, main stand	1			x						x						
15- 6	90506-29054	SPRING (122-27116-00)	1			x						x						
15- 7	260-27411-00	FOOTREST	1			x						x						
15- 8	122-27413-00	COVER, footrest	2			x						x						
15- 9	97301-08015	BOLT	1			x						x						
15-10	92901-08100	WASHER, spring	1			x						x						
15-11	296-27231-00	ROD, brake	1			x												
	180-27231-01	ROD, brake	1									x						
15-12	90506-20041	SPRING (109-27216-00)	1			x						x						
15-13	91401-20012	PIN, cotter	1			x						x						
15-14	92901-06600	WASHER, plate	1			x						x						
15-15	90501-10245	SPRING (180-27236-00)	1			x						x						
15-16	90249-12008	PIN (156-27237-00)	1			x						x						
15-17	90179-06176	NUT	1			x						x						

Fig. 16 FRONT FENDER · REAR FENDER

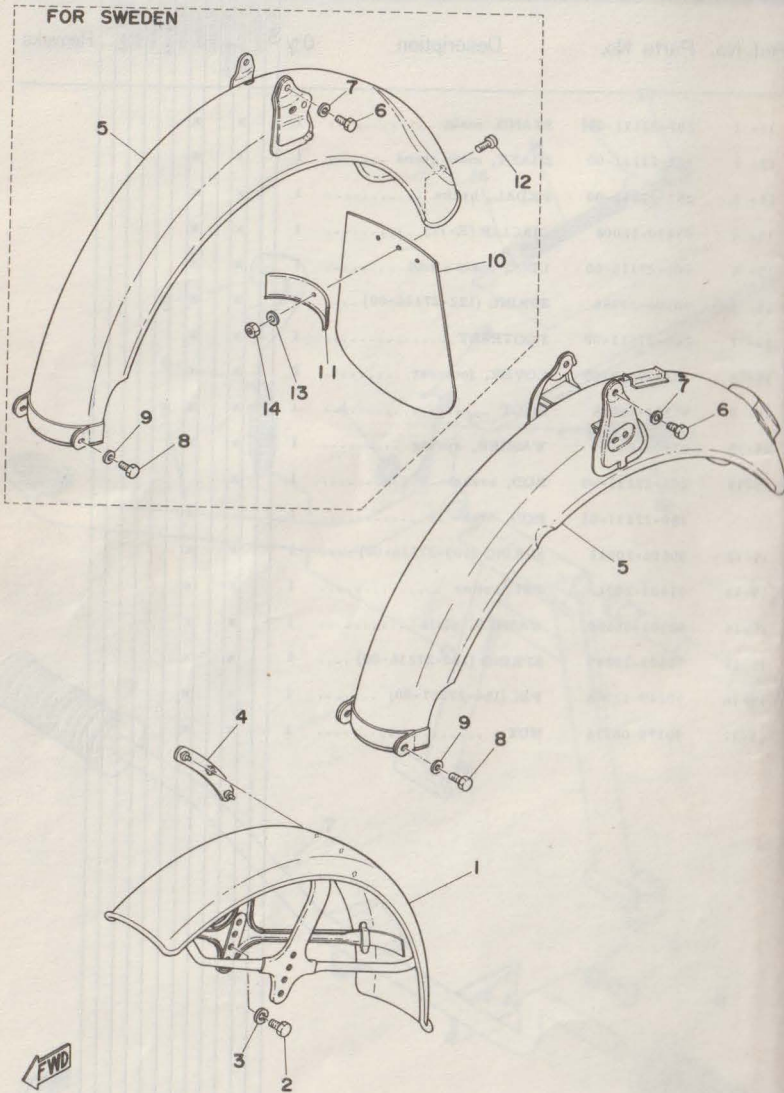

FRONT FENDER · REAR FENDER

Ref. No.	Parts No.	Description	Q'ty												Remarks		
				FRANCE	HOLLAND	SWITZERLAND	W. GERMANY	BELGIUM	SPAIN	FINLAND	ENGLAND	AUSTRIA	GERMANY	ITALY			
16- 1	260-21510-00-93	FRONT FENDER COMP. ...	1	x													
	471-21510-00-93	FRONT FENDER COMP. ...	1														x
16- 2	97301-08012	BOLT	4	x													x
16- 3	92901-08100	WASHER, spring	4	x													x
16- 4	122-21517-00	PAD, wire	1	x													x
16- 5	468-21610-40-93	REAR FENDER COMP.	1	x													
	471-21610-10-93	REAR FENDER COMP.	1														x
16- 6	97301-08015	BOLT	2	x													x
16- 7	92901-08100	WASHER, spring	2	x													x
16- 8	97321-06015	BOLT	2	x													x
16- 9	92901-06600	WASHER, plate	2	x													x
16-10	526-21621-00	FLAP, rear fender	1														x
16-11	471-21623-00	BAND, flap	1														x
16-12	92501-06012	SCREW, panhead	1														x
16-13	92901-06200	WASHER, plain	1														x
16-14	95301-06600	NUT	1														x

Fig. 17 FRONT FORK

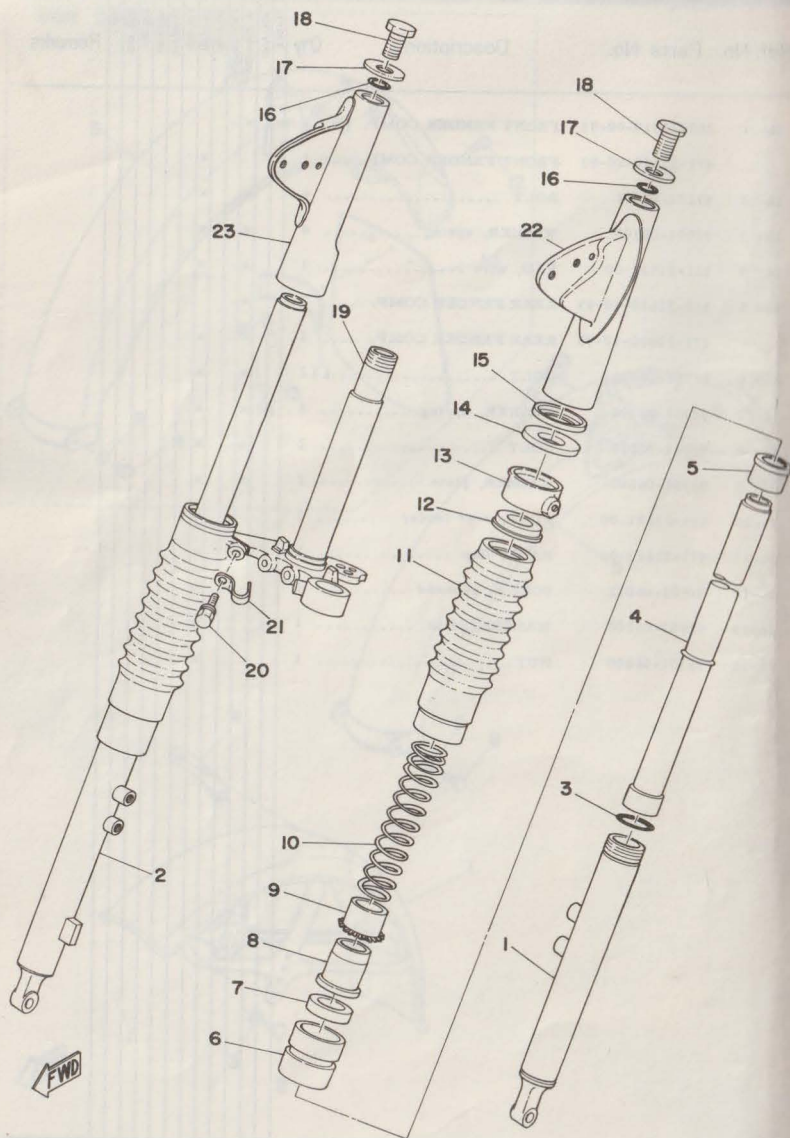

FRONT FORK

Ref. No.	Parts No.	Description	Q'ty	Applicable Machine No.	Remarks
17- 0-1	260-23101-31-35	FRONT FORK ASS'Y	1		
17- 1	260-23126-40-35	. TUBE, outer left	1		Silver
17- 2	260-23136-40-35	. TUBE, outer right	1		Silver
17- 3	207-23147-00	. O-RING	2		
17- 4	207-23124-01	. TUBE, inner left	1		
	207-23134-01	. TUBE, inner right	1		
17- 5	109-23125-00	. METAL, slide	2		
17- 6	209-23150-41	. OUTER NUT COMP.	2		
17- 7	109-23145-01	. OIL SEAL	2		
17- 8	109-23143-00	. SEAT, spring under	2		
17- 9	207-23117-00	. GUIDE, spring	4		
17-10	207-23141-00	. SPRING, fork	2		
17-11	196-23191-40	. BOOT	2		
17-12	209-23142-40	. SEAT, spring upper	2		
17-13	209-23122-40	. COVER, outer	2		
17-14	207-23163-00	. PACKING	2		
17-15	207-23116-01	. GUIDE, cover under	2		
17-16	307-23114-00	. PACKING	2		
17-17	207-23112-00	. WASHER, cap	2		
17-18	260-23111-40	. BOLT, cap	2		
17-19	260-23340-40-33	. UNDER BRACKET COMP.	1		Yamaha Black
17-20	122-23346-01	. BOLT	2		
17-21	260-23318-40	. HOLDER, wire	1		
17-22	260-23121-40-G6	COVER, upper left	1		Balboa Blue
	260-23121-40-K7	COVER, upper left	1		Ive Green
	260-23121-40-M3	COVER, upper left	1		Baja Brown
	260-23121-40-16	COVER, upper left	1		Metallic Cosmic Blue
	260-23121-40-26	COVER, upper left	1		Competition Yellow

Fig. 17 FRONT FORK

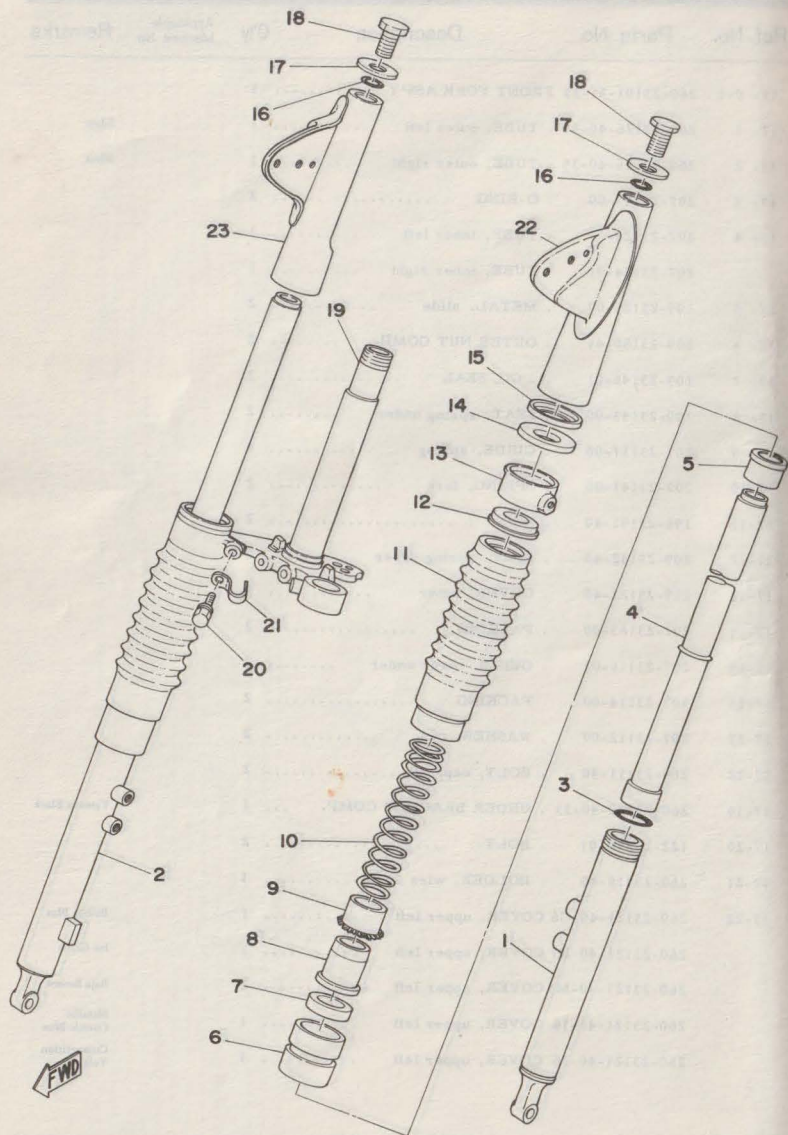

FRONT FORK

Ref. No.	Parts No.	Description	Q'ty	Applicable Machine No.	Remarks
17-23	260-23131-40-G6 COVER, upper right	1		Balboa Blue
	260-23131-40-K7 COVER, upper right	1		Ive Green
	260-23131-40-M3 COVER, upper right	1		Baja Brown
	260-23131-40-16 COVER, upper right	1		Metallic Cosmic Blue
	260-23131-40-26 COVER, upper right	1		Competition Yellow

Fig. 18 STEERING

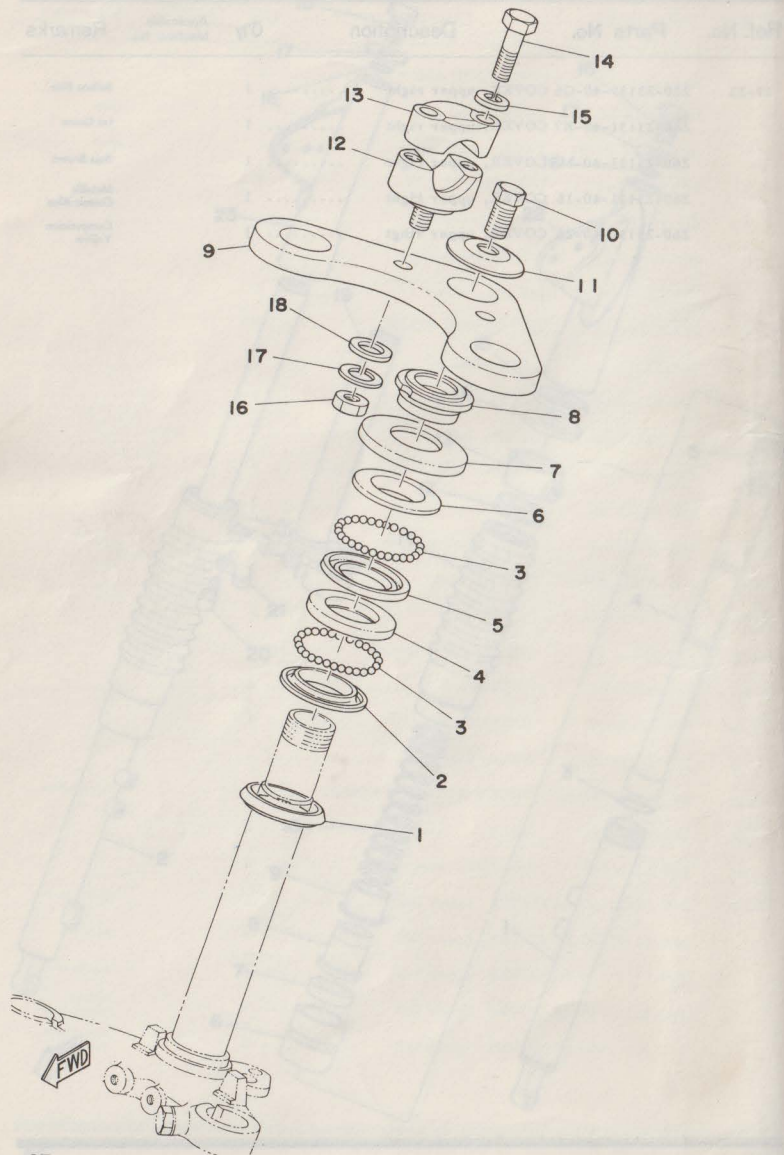

STEERING

Ref. No.	Parts No.	Description	Q'ty	Applicable Machine No.	Remarks
18- 1	164-23462-00	SEAL, dust	1		
18- 2	156-23411-00	RACE, ball 1	1		
18- 3	93501-04011	BALL (1/4 inch)	38		
18- 4	156-23412-00	RACE, ball 2	1		
18- 5	183-23412-00	RACE, ball 2	1		
18- 6	183-23411-00	RACE, ball 1	1		
18- 7	136-23415-00	COVER, ball race	1		
18- 8	90179-25051	NUT (122-23453-00)	1		
18- 9	185-23435-00-98	CROWN, handle	1		Frosting Black
18-10	90105-10006	BOLT (122-23451-00)	1		
18-11	90209-10021	WASHER (122-23443-00)	1		
18-12	462-23442-00	HOLDER, handle under	2		
18-13	122-23441-00	HOLDER, handle upper	2		
18-14	91214-06035	BOLT	4		
18-15	92901-06100	WASHER, spring	4		
18-16	95301-10600	NUT, hexagon	2		
18-17	92901-10100	WASHER, spring	2		
18-18	92901-10600	WASHER, plate	2		

Fig. 19 HANDLE · WIRE

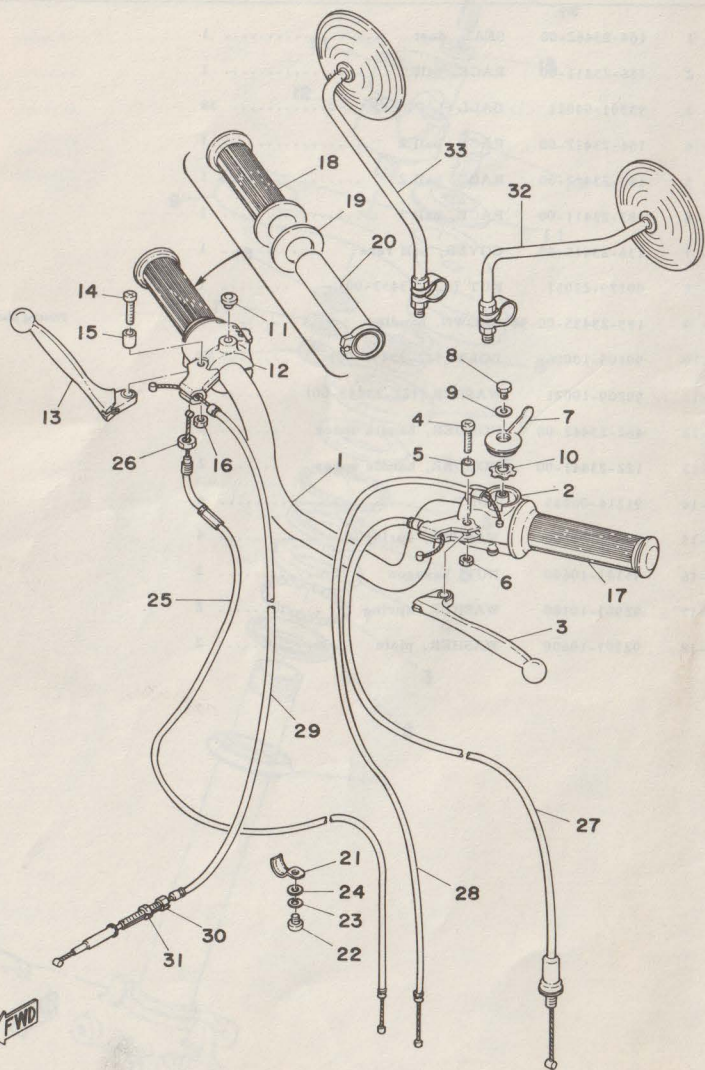

HANDLE · WIRE

Ref. No.	Parts No.	Description	Q'ty	FRANCE	HOLLAND	WEST GERMANY	FINLAND	ENGLAND	ITALY	REMARKS
19- 1	132-26111-01	HANDLE	1	x			x			Semi up
	283-26111-00	HANDLE	1	x			x			Alternate Parts Bredge
	183-26111-20	HANDLE	1	x			x			Alternate Parts Bar
19- 2	468-82710-01-94	LEVER HOLDER ASS'Y, left	1	x						Semi up, Bredge Bar
	381-82710-00	LEVER HOLDER ASS'Y, left	1				x			Semi up, Bredge
	381-82710-20	LEVER HOLDER ASS'Y, left	1				x			Bar
19- 3	137-83912-02-38	. LEVER, left	1	x			x			
19- 4	98503-05020	. SCREW, panhead	1	x			x			
19- 5	137-83913-01	. COLLAR, lever	1	x			x			
19- 6	95601-05100	. NUT	1	x			x			
19- 7	137-83941-01	LEVER, starter	1	x			x			
19- 8	97323-06008	BOLT	1	x			x			
19- 9	92901-06600	WASHER, plate	1	x			x			
19-10	90209-10131	WASHER	1	x			x			
19-11	90338-07011	PLUG (116-83931-00)	1	x			x			
19-12	109-82820-11-94	LEVER HOLDER ASS'Y, right	1	x			x			Semi up, Bredge Bar
19-13	137-83922-02-38	. LEVER, right	1	x			x			
19-14	98503-05020	. SCREW, panhead	1	x			x			
19-15	137-83913-01	. COLLAR, lever	1	x			x			
19-16	95601-05100	. NUT	1	x			x			
19-17	136-26241-00	GRIP, left	1	x			x			
19-18	137-26242-60	GRIP, right	1	x			x			
19-19	150-26249-00	RING, leaf	1	x			x			
19-20	137-26243-60	TUBE, guide	1	x			x			
19-21	90462-06009	CLIP (128-26278-00)	1	x			x			
19-22	92501-06008	SCREW, panhead	1	x			x			
19-23	92901-06100	WASHER, spring	1	x			x			

Fig. 19 HANDLE · WIRE

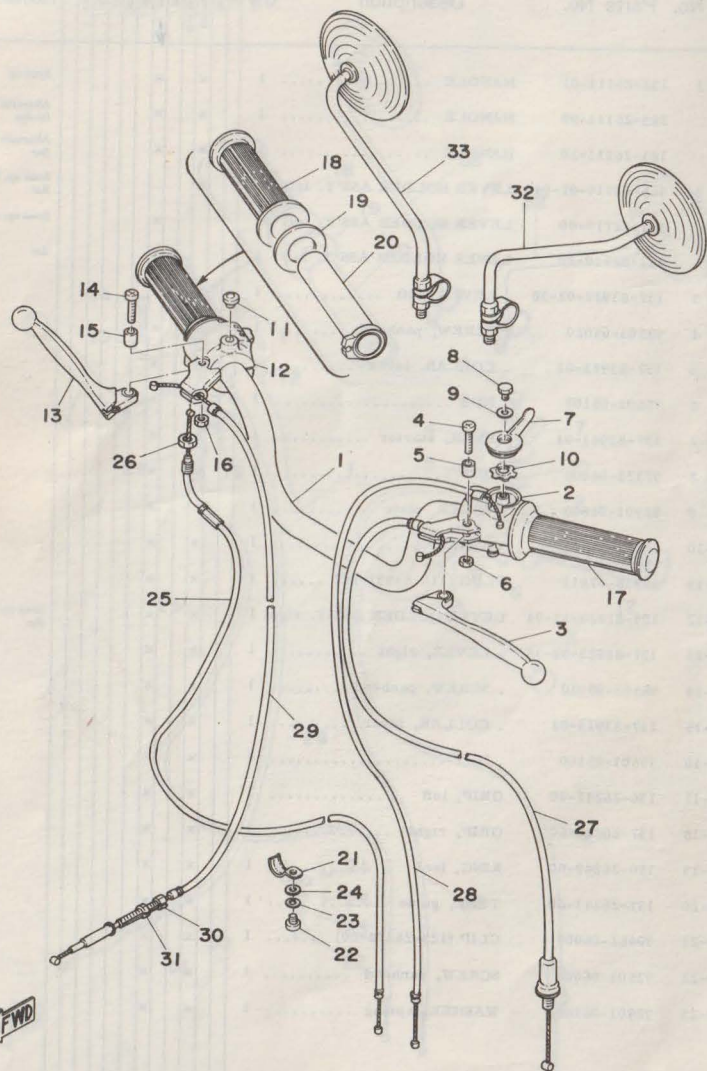

HANDLE · WIRE

Ref. No.	Parts No.	Description	Q'ty	FRANCE	HOLLAND	W. GERMANY	SWITZERLAND	BELGIUM	SWEDEN	FINLAND	GERMANY	NORWAY	DENMARK	ITALY	Remarks
19-24	92901-06600	WASHER, plate	1	x					x	x					
19-25	394-26311-00	WIRE, throttle (845mm)	1	x					x	x					Semi up
	394-26311-10	WIRE, throttle (900mm)	1	x					x	x					Alternate Parts Bredge
	394-26311-20	WIRE, throttle (750mm)	1	x					x	x					Alternate Parts Bar
19-26	95301-10700	NUT, hexagon	1	x					x	x					Semi up
19-27	260-26335-00	WIRE, clutch (970mm)	1	x					x	x					Semi up
	260-26335-10	WIRE, clutch (1030mm)	1	x					x	x					Alternate Parts Bredge
	260-26335-20	WIRE, clutch (860mm)	1	x					x	x					Alternate Parts Bar
19-28	260-26331-00	WIRE, starter (910mm)	1	x					x	x					Semi up
	137-26331-11	WIRE, starter (985mm)	1	x					x	x					Alternate Parts Bredge
	137-26331-30	WIRE, starter (835mm)	1	x					x	x					Alternate Parts Bar
19-29	260-26341-00	WIRE, brake (970mm)	1	x					x	x					Semi up
	132-26341-10	WIRE, brake (1020mm)	1	x					x	x					Alternate Parts Bredge
	109-26341-20	WIRE, brake (895mm)	1	x					x	x					Alternate Parts Bar
19-30	90123-06011	BOLT (109-26345-00)	1	x					x	x					
19-31	90179-06143	NUT (109-26344-00)	1	x					x	x					
19-32	407-26290-50	BACK MIRROR ASS'Y, left	1	x					x	x					
19-33	407-26290-60	BACK MIRROR ASS'Y, right	1	x					x	x					Alternate Parts

Fig. 20 FUEL TANK

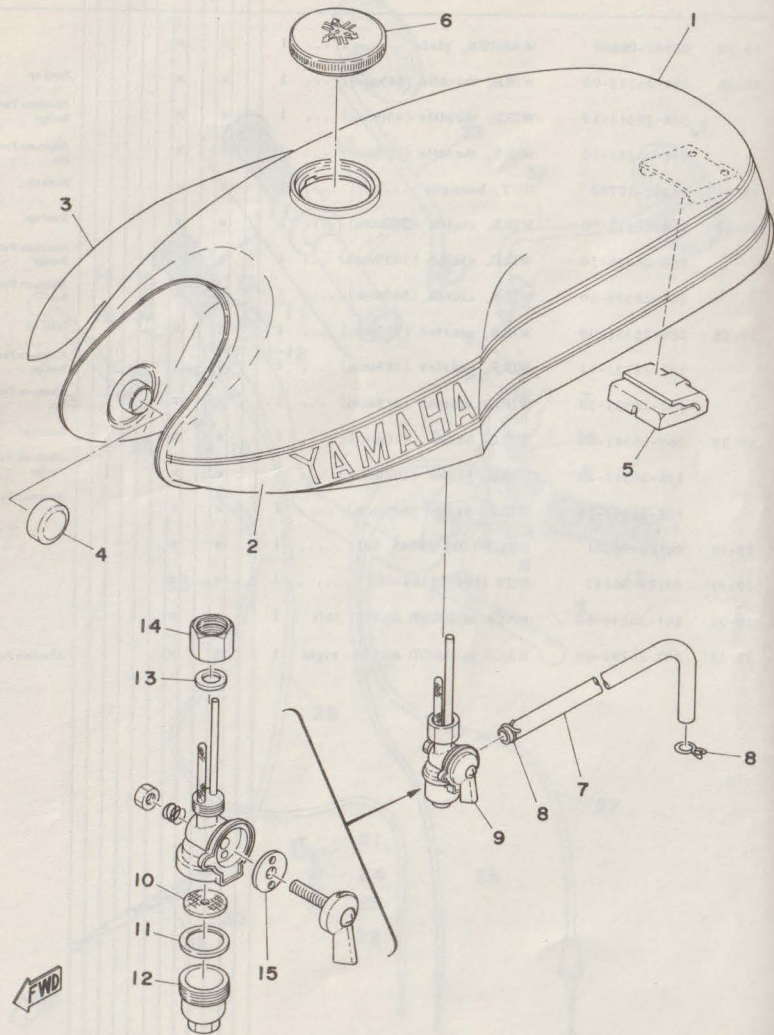

FUEL TANK

Ref. No.	Parts No.	Description	Q'ty	Applicable Machine No.	Remarks
20- 1	467-24110-00-06	FUEL TANK COMP.	1		Balboa Blue
	467-24110-00-07	FUEL TANK COMP.	1		Ive Green
	467-24110-00-01	FUEL TANK COMP.	1		Baja Brown
	467-24110-00-02	FUEL TANK COMP.	1		Metallic Cosmic Blue
	467-24110-00-05	FUEL TANK COMP.	1		Competition Yellow
20- 2	467-24244-00	. GRAPHIC, fuel tank left	1		
20- 3	467-24245-00	. GRAPHIC, fuel tank right	1		
20- 4	122-24181-00	DAMPER, locating 1	2		
20- 5	467-24184-00	DAMPER, locating 2	1		
20- 6	122-24610-01	CAP ASS'Y	1		
20- 7	90445-09114	HOSE (647-24314-00 5-500) ...	1		
20- 8	90467-08003	CLIP (101-24356-00)	2		
20- 9	367-24500-02	FUEL COCK ASS'Y	1		
20-10	355-24515-00	. NET, filter	1		
20-11	102-24522-01	. GASKET, filter	1		
20-12	122-24521-00	. CUP, filter	1		
20-13	122-24532-00	. GASKET, nut	1		
20-14	603-24531-01	. NUT	1		
20-15	355-24523-00	. VALVE	1		

Fig. 21 SEAT

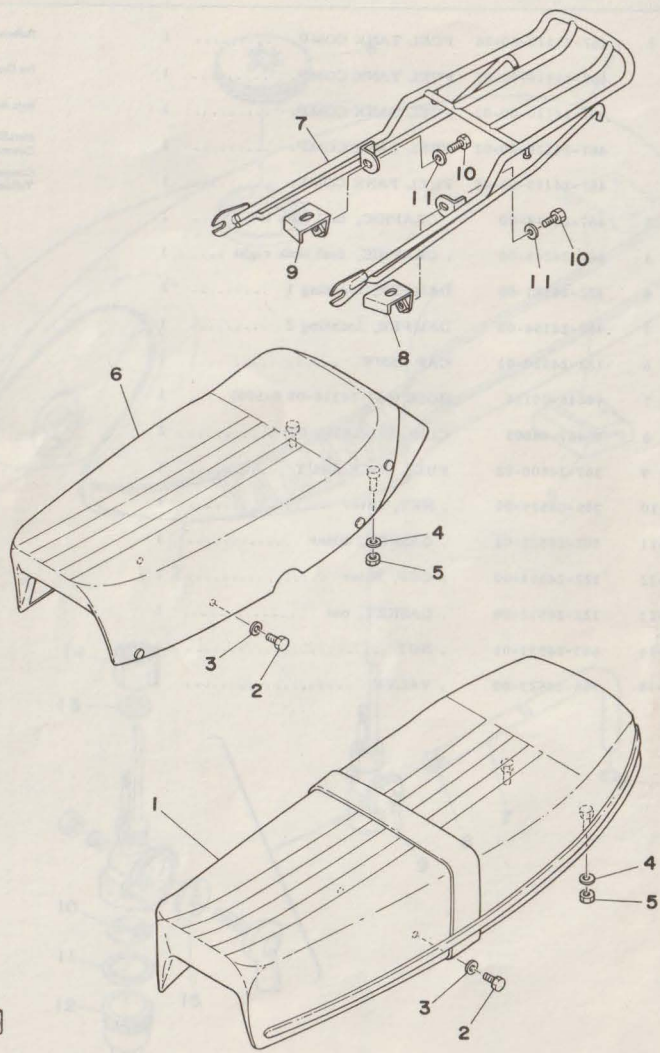

SEAT

Ref. No.	Parts No.	Description	Q'ty	FRANCE	HOLLAND	WEST GERMANY	SWITZERLAND	FINLAND	SPAIN	ENGLAND	IRELAND	NETHERLANDS	GERMANY	ITALY	Remarks
21- 1	468-24730-00	DOUBLE SEAT ASS'Y	1	x											
21- 1-1	468-24731-00	. COVER, double seat	1	x											
21- 2	97301-08015	BOLT	2	x		x									
21- 3	92901-08200	WASHER, plain	2	x		x									
21- 4	92901-08600	WASHER, plain	2	x		x									
21- 5	95301-08600	NUT	2	x		x									
21- 6	471-24770-00-G6	SEMI DOUBLE SEAT ASS'Y	1					x							Balboa Blue
	471-24770-00-K7	SEMI DOUBLE SEAT ASS'Y	1					x							Ive Green
	471-24770-00-M3	SEMI DOUBLE SEAT ASS'Y	1					x							Baja Brown
	471-24770-00-16	SEMI DOUBLE SEAT ASS'Y	1					x							Metallic Cosmic Blu
	471-24770-00-26	SEMI DOUBLE SEAT ASS'Y	1					x							Competition Yellow
21- 6-1	471-24771-00	. COVER, semi double seat	1					x							
21- 7	206-24830-00	SUB CARRIER ASS'Y	1					x							
21- 8	212-24832-00	BRACKET, carrier left	1					x							
21- 9	212-24833-00	BRACKET, carrier right	1					x							
21-10	97301-08015	BOLT	2					x							
21-11	92901-08200	WASHER, plain	2					x							

Fig. 22 FRONT WHEEL

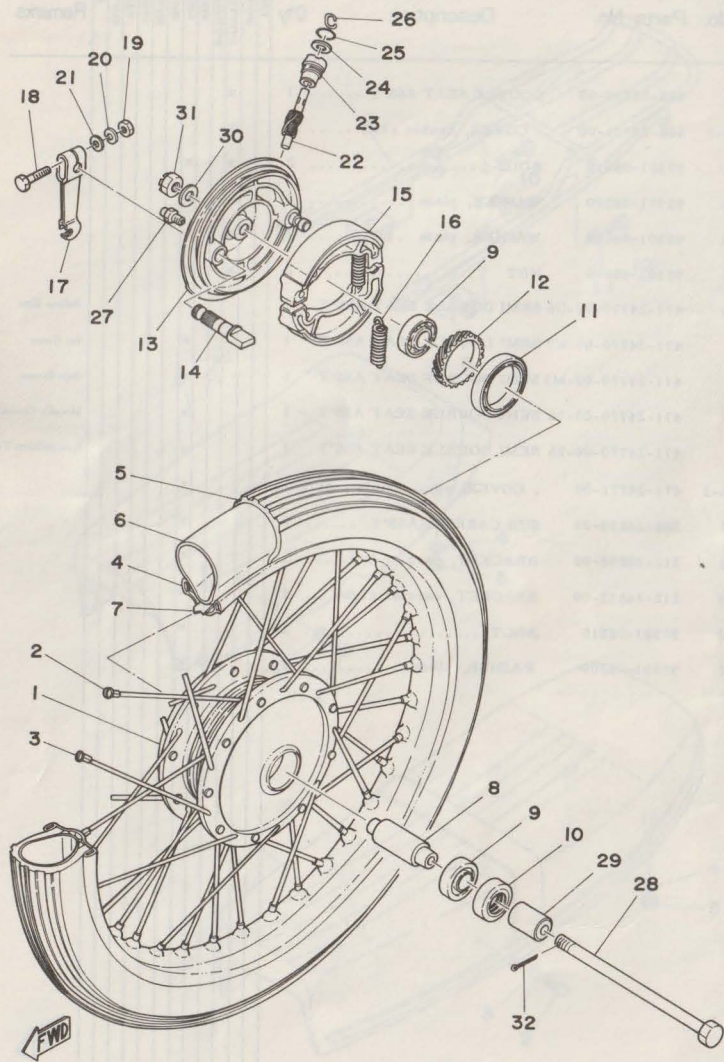

FRONT WHEEL

Ref. No.	Parts No.	Description	Q'ty	FRANCE	HOLLAND	GERMANY	SWEDEN	FINLAND	DENMARK	NORWAY	ENGLAND	AUSTRIA	ITALY	Remarks
22- 1	109-25111-00-35	HUB, front	1	x										
22- 0-1	109-25104-00	SPOKE SET	1s	x										
22- 2	109-25196-90	SPOKE SET, inner (10 PCS)	1s	x										
22- 3	109-25197-90	SPOKE SET, outer (10 PCS)	1s	x										
22- 4	94416-17096	RIM (1.60-17)	1	x										
	94412-17002	RIM (1.20-17)	1											
22- 5	94125-17141	TIRE, front (2.50-17-4PR)	1	x										
	94122-17008	TIRE, front (2.25-17-4PR)	1											
22- 6	94225-17005	TUBE (2.50-17)	1	x										
	94222-17003	TUBE (2.25-17)	1											
22- 7	94330-17023	BAND, rim (2.50-17)	1	x										
	94326-17019	BAND, rim (2.25-17)	1											
22- 8	102-25117-00	SPACER, bearing	1	x										
22- 9	93306-20204	BEARING (B620Z)	2	x										
22-10	93106-20001	OIL SEAL (DD-20-35-7)	1	x										
22-11	93107-42001	OIL SEAL (OS-42-52.5-7)	1	x										
22-12	109-25135-00	GEAR, drive	1	x										
22-13	109-25121-01-35	PLATE, brake shoe	1	x										
23-14	122-25351-01	CAMSHAFT	1	x										
22-15	326-25330-10	BRAKE SHOE COMP.	2	x										
22-16	90506-16034	SPRING (102-25333-00)	2	x										
22-17	109-25155-00	LEVER, cam shaft	1	x										
22-18	97301-06030	BOLT	1	x										
22-19	90185-06034	NUT U	1	x										
	95301-06600	NUT	1											
22-20	92901-06100	WASHER, spring	1											
22-21	92901-06600	WASHER, plate	1											
22-22	141-25138-00	GEAR, meter	1	x										

Fig. 22 FRONT WHEEL

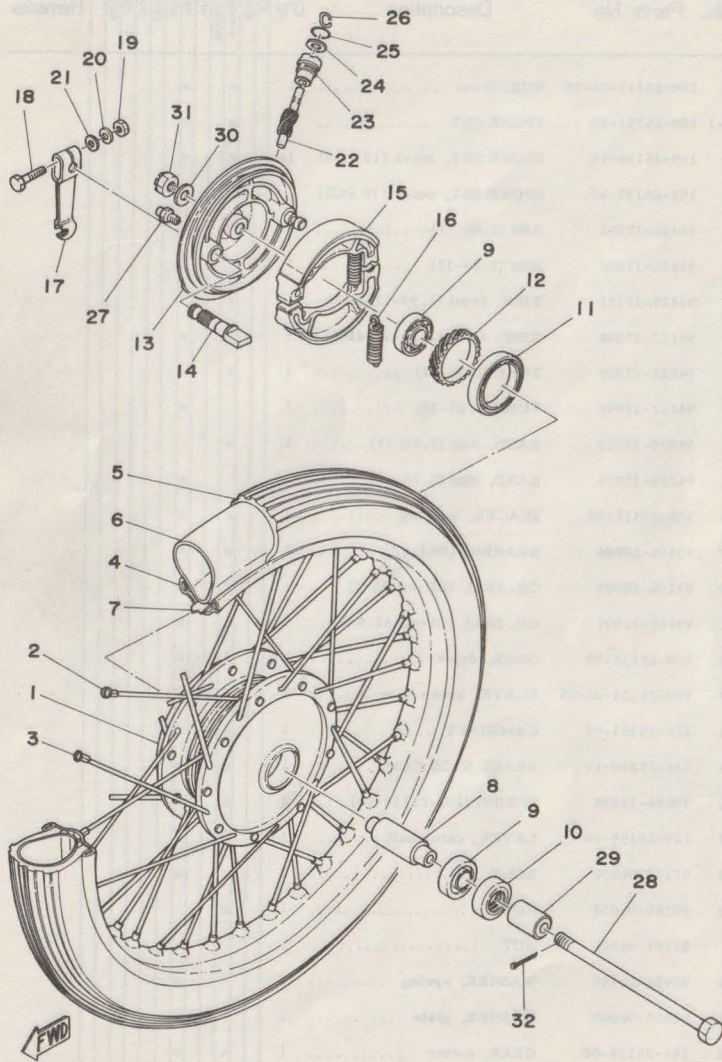

FRONT WHEEL

Ref. No.	Parts No.	Description	Q'ty	FRANCE	HOLLAND	GERMANY	SWITZERLAND	FINLAND	ENGLAND	ITALY	REMARKS
22-23	109-25136-00	BUSHING	1	x				x			
22-24	93104-07003	OIL SEAL (SO-7-14-4)	1	x				x			
22-25	93210-14104	O-RING (2.4-13.8)	1	x				x			
22-26	102-25137-00	RING, stop	1	x				x			
22-27	93700-06001	NIPPLE, grease	1	x				x			
22-28	451-25181-01	SHAFT, wheel	1	x				x			
22-29	90387-10081	COLLAR (128-25183-00) ...	1	x				x			
22-30	90201-10123	WASHER (256-21715-01) ...	1	x				x			
22-31	90171-10004	NUT, castle (353-25182-00)	1	x				x			
22-32	91401-20020	PIN, cotter	1	x				x			

Fig. 23 REAR WHEEL

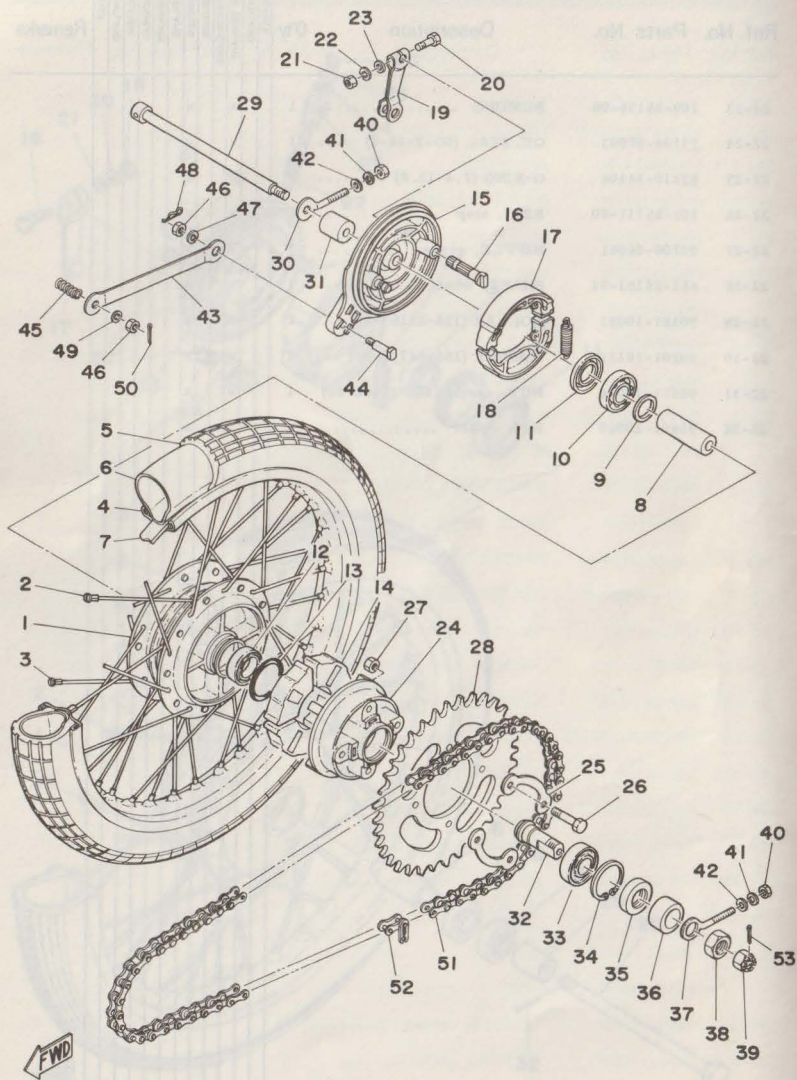

REAR WHEEL

Ref. No.	Parts No.	Description	Q'ty	FRANCE	HOLLAND	WEST GERMANY	SWITZERLAND	BELGIUM	SWEDEN	FINLAND	DENMARK	NORWAY	AUSTRIA	ENGLAND	ITALY	Remarks
23- 1	132-25311-00-38	HUB, rear	1	x					x							
23- 0-1	474-25304-40	SPOKE SET	1s	x												
	122-25304-00	SPOKE SET	1s						x							
23- 2	474-25396-90	SPOKE SET, inner (10 PCS)	1s	x												
	122-25396-90	SPOKE SET, inner (10 PCS)	1s						x							
23- 3	474-25397-90	SPOKE SET, outer (10 PCS)	1s	x												
	122-25397-90	SPOKE SET, outer (10 PCS)	1s						x							
23- 4	94418-17109	RIM (1.85-17)	1	x												
	94414-17003	RIM (1.40-17)	1						x							
23- 5	94127-17137	TIRE, rear (2.75-17-6PR)	1	x												
	94125-17012	TIRE, rear (2.50-17-4PR)	1						x							
23- 6	94227-17032	TUBE (2.70-17)	1	x												
	94225-17005	TUBE (2.50-17)	1						x							
23- 7	94330-17023	BAND, rim (3.00-17)	1	x					x							
23- 8	102-25317-00	SPACER, bearing	1	x					x							
23- 9	102-25315-00	FLANG, spacer	1	x					x							
23-10	93306-30101	BEARING (B6301)	1	x					x							
23-11	93104-21016	OIL SEAL (SO-21-37-7)	1	x					x							
23-12	93306-30103	BEARING (B6301Z)	1	x					x							
23-13	93210-41041	O-RING (4-40.5)	1	x					x							
23-14	304-25364-00	DAMPER, clutch	4	x					x							
23-15	102-25321-00-38	PLATE, brake shoe	1	x					x							
23-16	122-25351-01	CAMSHAFT	1	x					x							
23-17	326-25330-10	BRAKE SHOE COMP.	2	x					x							
23-18	90506-16034	SPRING (102-25333-00)	2	x					x							
23-19	122-25355-00	LEVER, cam shaft	1	x					x							
23-20	97301-06030	BOLT	1	x					x							

Fig. 23 REAR WHEEL

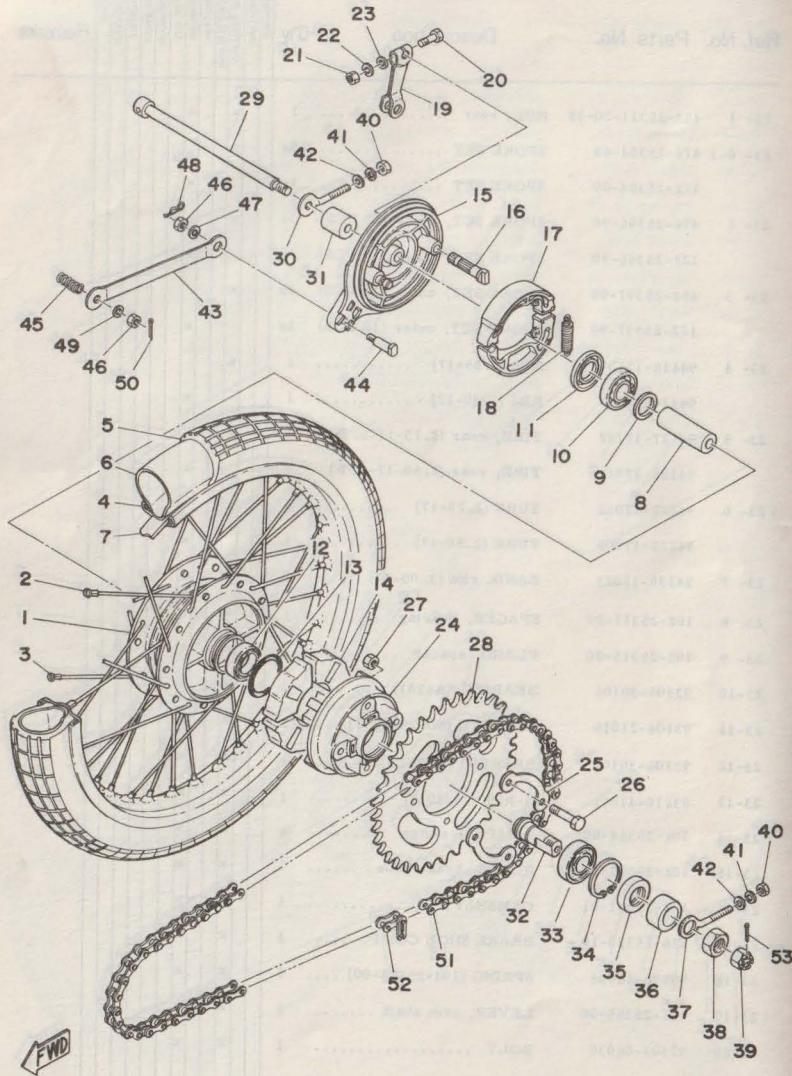

REAR WHEEL

Ref. No.	Parts No.	Description	Q'ty	FRANCE	GERMANY	ENGLAND	ITALY	SPAIN	NETHERLANDS	SCANDINAVIA	SWITZERLAND	USA	REMARKS
23-21	90185-06034	NUT U	1	x									
	95301-06600	NUT	1			x							
23-22	92901-06100	WASHER, spring	1			x							
23-23	92901-06600	WASHER, plate	1			x							
23-24	132-25366-01	CLUTCH, hub	1	x	x								
23-25	102-25412-00	WASHER, lock	2	x	x	x							
23-26	90109-08057	BOLT (102-25411-01)	4	x	x	x							
23-27	90170-08157	NUT, hexagon	4	x	x	x							
23-28	283-25444-10	GEAR, sprocket wheel (44T)	1	x									
	122-25439-11	GEAR, sprocket wheel (39T)	1			x							
23-29	357-25381-00	SHAFT, wheel	1	x	x								
23-30	102-25389-00	PULLER, chain right	1	x	x								
23-31	90387-12412	COLLAR (102-25383-00)	1	x	x	x							
23-32	102-25387-02	SHAFT, sprocket	1	x	x	x							
23-33	93306-00406	BEARING (B6004Z)	1	x	x	x							
23-34	93420-42007	CIRCLIP (R-42)	1	x	x	x							
23-35	93106-30004	OIL SEAL (DD-30-42-8)	1	x	x	x							
23-36	90387-18143	COLLAR (102-25386-01)	1	x	x	x							
23-37	127-25388-00	PULLER, chain left	1	x	x								
23-38	90170-18165	NUT, hexagon	1	x	x	x							
23-39	90171-10004	NUT (353-25182-00)	1	x	x	x							
23-40	95301-06600	NUT	2	x	x	x							
23-41	92901-06100	WASHER, spring	2	x	x	x							
23-42	92901-06200	WASHER, plain	2	x	x	x							
23-43	102-25371-00	BAR, tension	1	x	x	x							
23-44	90109-08183	BOLT (102-25373-00)	1	x	x	x							
23-45	90501-20129	SPRING (102-25374-00)	1	x	x	x							
23-46	95301-08700	NUT, hexagon	1	x	x	x							

Fig. 23 REAR WHEEL

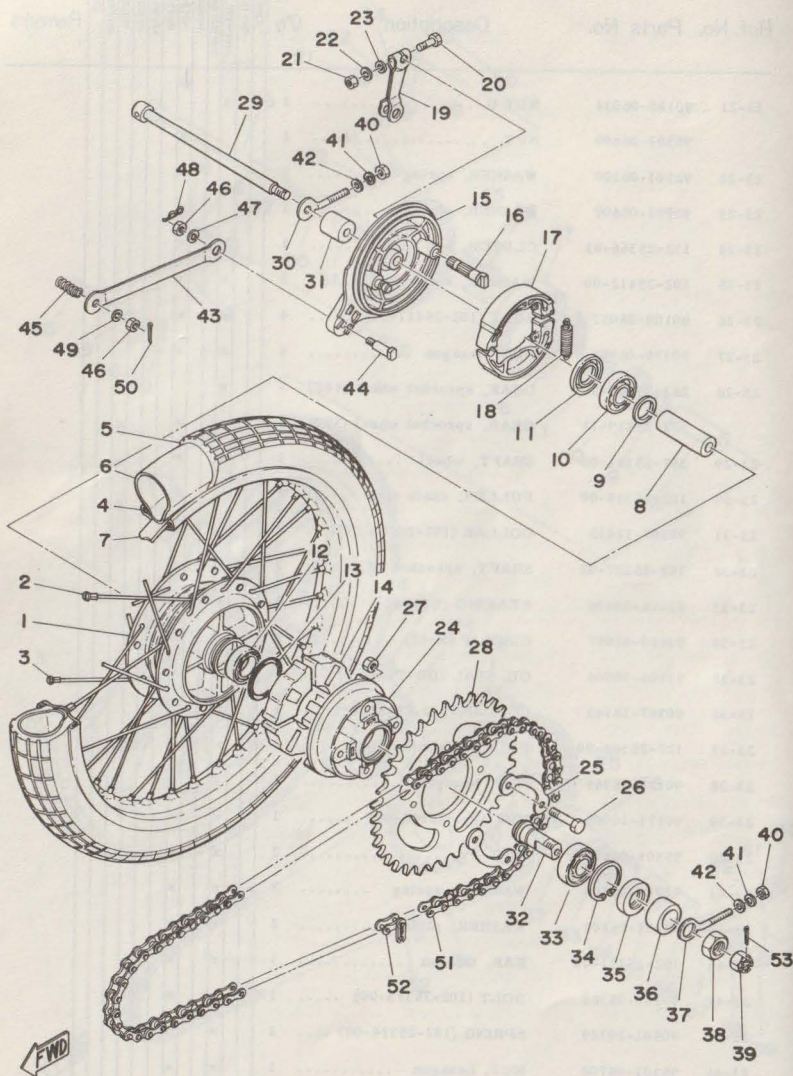

REAR WHEEL

Ref. No.	Parts No.	Description	Q'ty	EXHAUST	ENGINE	CLUTCH	CRANK	CONNECTING ROD	PISTON	VALVE	REMARKS
23-47	92901-08100	WASHER, spring	1	x	x						
23-48	90468-12007	CLIP (102-25375-00)	1	x	x						
23-49	92901-08600	WASHER, plain	1	x	x						
23-50	91401-20012	PIN, cotter	1	x	x						
23-51	94504-20101	CHAIN (DK420-101L)	1	x							
	94504-20093	CHAIN (DK420-93L)	1					x			
23-52	94604-20001	JOINT, chain	1	x	x						
23-53	91401-20020	PIN, cotter	1	x	x						

Fig. 24 HEAD LAMP 1

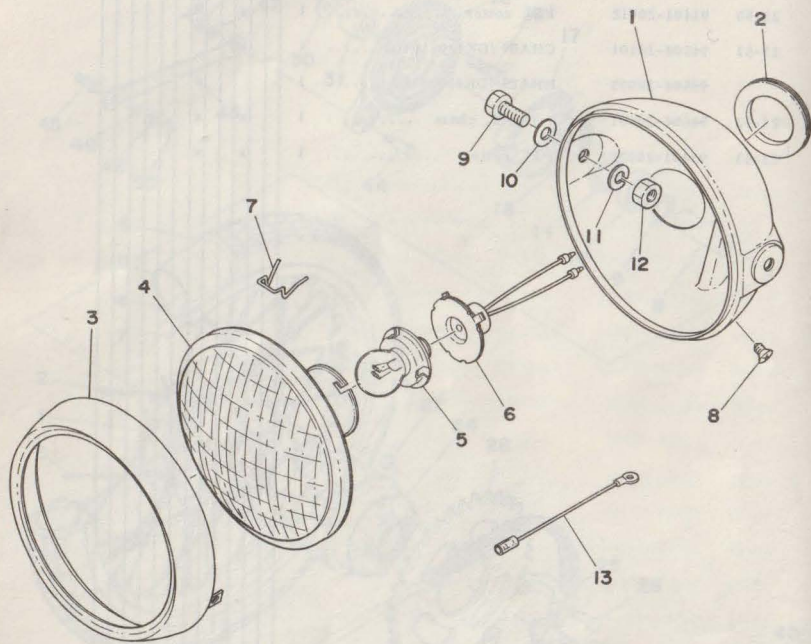

HEAD LAMP 1

Ref. No.	Parts No.	Description	Q'ty	FLANGE	REFLECTOR	SOCKET	LENS	LENS ASS'Y	SOCKET ASS'Y	BULB	SPRING	REFLECTOR SET	RIM FITTING	SCREW	BOLT	WASHER	NUT	WIRE	Remarks
24- 1	241-84330-00-G6	BODY ASS'Y	1	X															Balboa Blue
	241-84330-00-K7	BODY ASS'Y	1	X															Ive Green
	241-84330-00-M3	BODY ASS'y	1	X															Baja Brown
	241-84330-00-16	BODY ASS'Y	1	X															Metallic Cosmic Blue
	241-84330-00-26	BODY ASS'Y	1	X															Competition Yellow
24- 2	150-84153-00	. GROMMET	2	X															
24- 0-1	468-84103-40	HEAD LAMP UNIT ASS'Y	1	X															
24- 3	195-84315-01	. RIM, head lamp	1	X															
24- 4	468-84120-40	. LENS ASS'Y	1	X															
24- 5	468-84114-40	. BULB (6V-15/15W)	1	X															
24- 6	468-84112-40	. SOCKET ASS'Y	1	X															
24- 7	195-84324-00	. SPRING, reflector set ...	3	X															
24- 8	195-84325-00	SCREW, rim fitting	1	X															
24- 9	97303-08018	BOLT	2	X															
24-10	92903-08200	WASHER, plain	2	X															
24-11	92901-08100	WASHER, spring	2	X															
24-12	95301-08700	NUT	2	X															
24-13	173-84313-00	WIRE, earth	1	X															

Fig. 25 HEAD LAMP 2

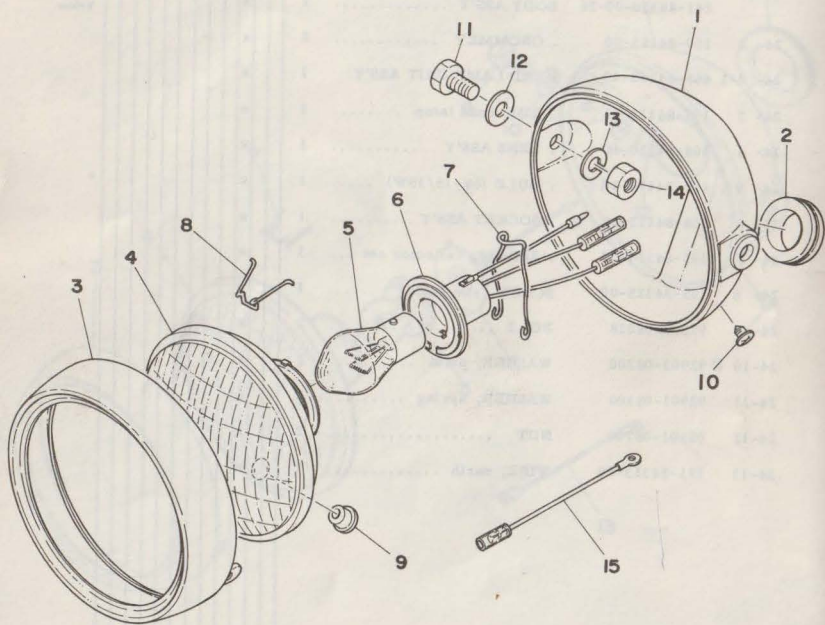

FWD

HEAD LAMP 2

Ref. No.	Parts No.	Description	Q'ty												Remarks	
				ITALY	ENGLAND	AUSTRALIA	INDONESIA	SPAIN	FRANCE	GERMANY	NETHERLANDS	SWITZERLAND	USA	JAPAN		
25- 1	241-84330-00-G6	BODY ASS'Y	1													Balboa Blue
	241-84330-00-K7	BODY ASS'Y	1													Ive Green
	241-84330-00-M3	BODY ASS'Y	1													Baja Brown
	241-84330-00-16	BODY ASS'Y	1													Metallic Cosmic Blue
	241-84330-00-26	BODY ASS'Y	1													Competition Yellow
25- 2	150-84153-00	GROMMET	2													
25- 0-1	381-84103-91	HEAD LAMP UNIT ASS'Y	1													
25- 3	290-84115-21	RIM, head lamp	1													
25- 4	381-84120-91	LENS ASS'Y	1													
25- 5	381-84114-90	BULB (6V-15/15W)	1													
25- 6	381-84112-91	SOCKET ASS'Y	1													
25- 7	308-84135-21	SPRING	1													
25- 8	290-84124-21	SPRING, reflector set	3													
25- 9	381-84154-90	BUSHING	1													
25-10	195-84325-00	SCREW, rim fitting	1													
25-11	97303-08018	BOLT	2													
25-12	92903-08200	WASHER, plain	2													
25-13	92901-08100	WASHER, spring	2													
25-14	95301-08700	NUT	2													
25-15	173-84313-00	WIRE, earth	1													

Fig. 26 SPEEDOMETER

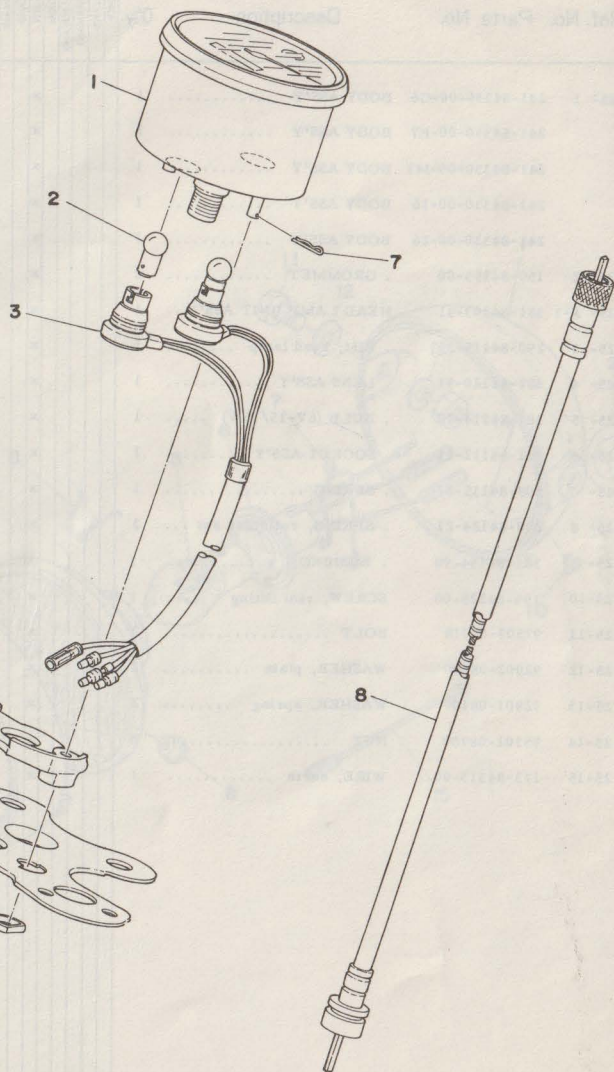

SPEEDOMETER

Ref. No.	Parts No.	Description	Q'ty	Applicable Machine No.	Remarks
26- 1	260-83510-11	SPEEDOMETER ASS'Y	1		Km/h
26- 2	122-83516-10	. BULB (6V-3W)	2		
26- 3	260-83520-11	. SOCKET ASS'Y	1		
26- 4	237-83523-00	DAMPER	1		
26- 5	467-83519-00-98	BRACKET, meter	1		Frosting Black
26- 6	90209-05029	WASHER (214-83524-00)	2		
26- 7	90468-10050	CLIP (156-83525-00)	2		
26- 8	260-83550-00	SPEEDOMETER CABLE ASS'Y..	1		

Fig. 27 TAIL LAMP

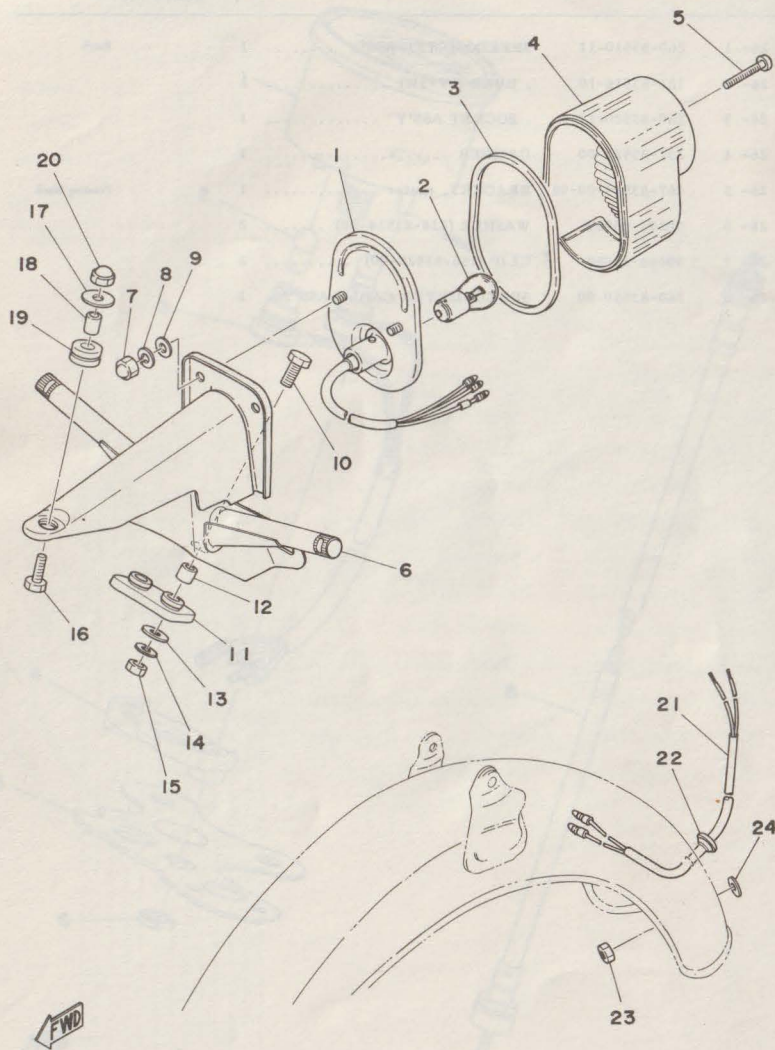

TAIL LAMP

Ref. No.	Parts No.	Description	Q'ty	FRANCE	GERMANY	HOLLAND	ITALY	JAPAN	KOREA	NETHERLANDS	NORWAY	SPAIN	SWEDEN	SWITZERLAND	UNITED KINGDOM	USA	REMARKS
27- 0-1	468-84510-40	TAIL LAMP UNIT ASS'Y ...	1	x													
27- 1	468-84511-40	. BASE, tail lamp	1	x													
27- 2	260-84514-40	. BULB (6V-21/5W)	1	x													*
27- 3	122-84523-30	. GASKET, tail lens	1	x													
27- 4	375-84521-40	. LENS, tail lamp	1	x													
27- 5	127-84524-30	. SCREW, lens fitting	2	x													
27- 6	420-84551-40-35	BRACKET, license	1	x													Silver
27- 7	95301-06800	NUT, cap	2	x													
27- 8	92901-06100	WASHER, spring	2	x													
27- 9	92901-06200	WASHER, plain	2	x													
27-10	97301-06020	BOLT, hexagon	2	x													
27-11	214-84553-01	DAMPER	1	x													
27-12	90387-06241	COLLAR	2	x													
27-13	90201-06059	WASHER (838-77728-00) ..	2	x													
27-14	92901-06100	WASHER, spring	2	x													
27-15	95301-06600	NUT	2	x													
27-16	97301-06020	BOLT	1	x													
27-17	90209-06095	WASHER (102-28323-00) ...	1	x													
27-18	90387-07390	COLLAR	1	x													
27-19	90480-14102	GROMMET (214-21717-00) ..	1	x													
27-20	95303-06800	NUT, cap	1	x													
27-21	471-84517-01	CORD, tail lamp	1								x						
27-22	90480-12013	GROMMET (152-84518-00) ...	1								x						
27-23	95301-05600	NUT, hexagon	2								x						
27-24	92901-05200	WASHER, plain	1								x						

Fig. 28 FLASHER LAMP 1

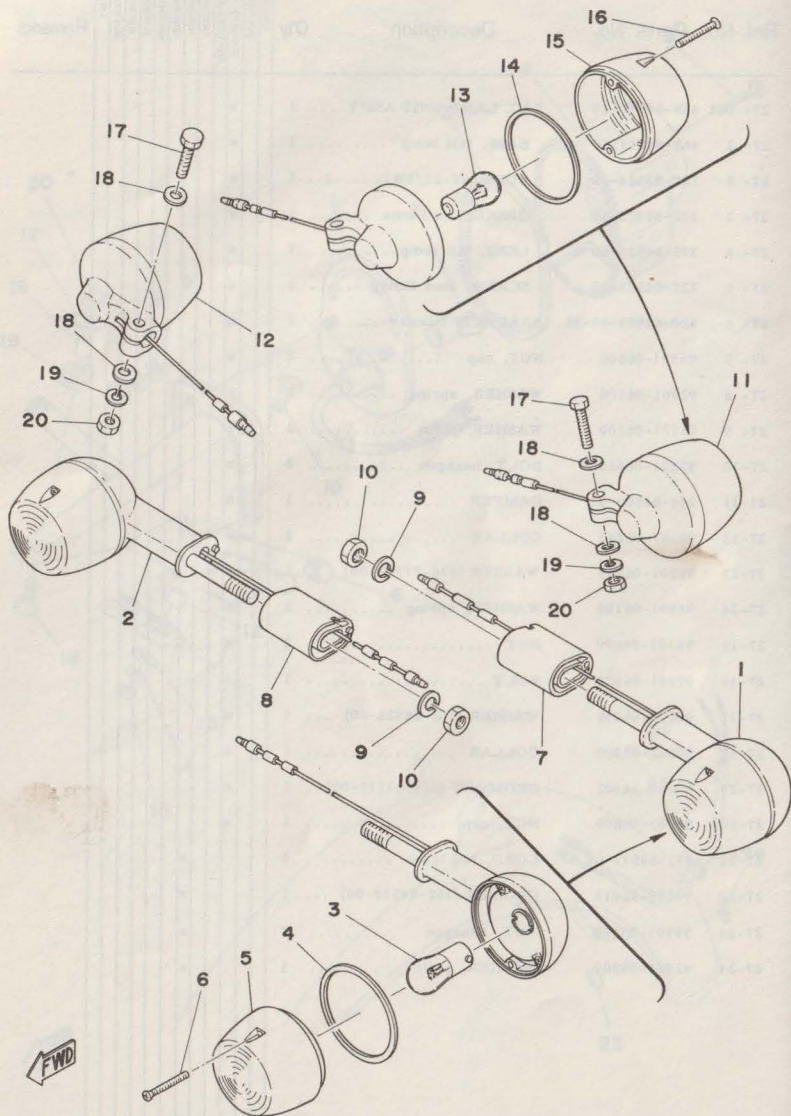

FLASHER LAMP 1

Ref. No.	Parts No.	Description	Q'ty	FRANCE	HOLLAND	GERMANY	SWITZERLAND	BEIGIUM	FINLAND	DENMARK	NORWAY	ENGLAND	ITALY	Remarks
28- 1	353-83310-30-93	FRONT FLASHER LAMP ASS'Y, left	1	x										
28- 2	353-83320-30-93	FRONT FLASHER LAMP ASS'Y, right	1	x										
28- 3	308-83311-30	. BULB, flasher (6V-21W)	2	x										*
28- 4	183-83313-70	. GASKET, flasher lens	2	x										
28- 5	183-83312-70	. LENS, flasher	2	x										
28- 6	183-83333-71	. SCREW, lens fitting	4	x										
28- 7	353-83316-30	COLLAR, flasher 1	1	x										
28- 8	353-83326-30	COLLAR, flasher 2	1	x										
28- 9	92901-08100	WASHER, spring	2	x										
28-10	95303-08700	NUT, hexagon	2	x										
28-11	474-83330-30-93	REAR FLASHER LAMP ASS'Y, left	1	x										
28-12	474-83340-30-93	REAR FLASHER LAMP ASS'Y, right	1	x										
28-13	308-83311-30	. BULB, flasher (6V-21W)	2	x										*
28-14	306-83313-40	. GASKET, flasher lens	2	x										
28-15	306-83332-40	. LENS, flasher	2	x										
28-16	183-83333-71	. SCREW, lens fitting	4	x										
28-17	97303-06030	BOLT, hexagon	2	x										
28-18	92903-06200	WASHER, plain	4	x										
28-19	92903-06100	WASHER, spring	2	x										
28-20	95301-06600	NUT	2	x										

Fig. 29 FLASHER LAMP 2

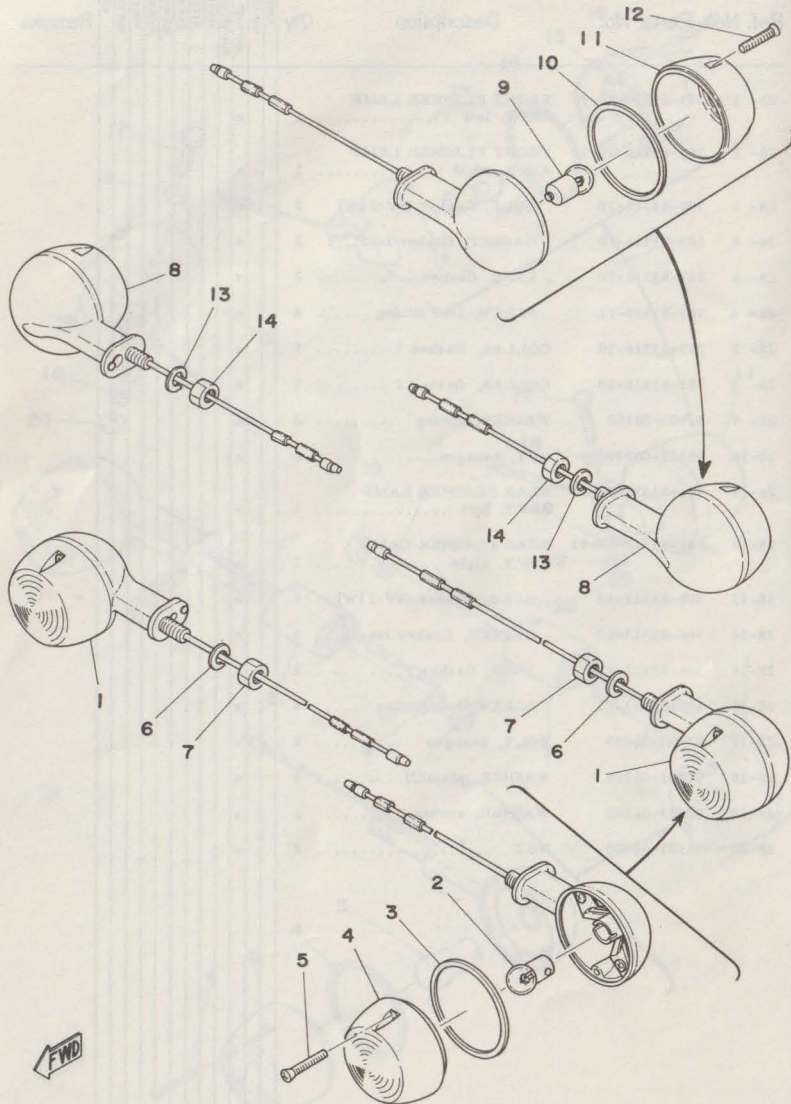

FLASHER LAMP 2

Ref. No.	Parts No.	Description	Q'ty	ITALY	ENGLAND	AUSTRIA	NORWAY	DENMARK	FINLAND	SWEDEN	SWITZERLAND	W. GERMANY	HOLLAND	FRANCE	Remarks
29- 1	260-83310-35-93	FRONT FLASHER LAMP ASS'Y	2						X						
29- 2	185-83311-10	. BULB, flasher (6V-8WG)	2						X						
29- 3	183-83313-70	. GASKET, flasher lens	2						X						
29- 4	183-83332-21	. LENS, flasher	2						X						
29- 5	183-83333-21	. SCREW, lens fitting	4						X						
29- 6	92901-08100	WASHER, spring	2						X						
29- 7	95301-08700	NUT, hexagon	2						X						
29- 8	206-83330-35-93	REAR FLASHER LAMP ASS'Y	2						X						
29- 9	185-83311-10	. BULB, flasher (6V-8WG)	2						X						
29-10	183-83313-70	. GASKET, flasher	2						X						
29-11	183-83332-21	. LENS, flasher	2						X						
29-12	183-83333-21	. SCREW, lens fitting	4						X						
29-13	92901-08100	WASHER, spring	2						X						
29-14	95301-08700	NUT, hexagon	2						X						

Fig. 30 ELECTRICAL

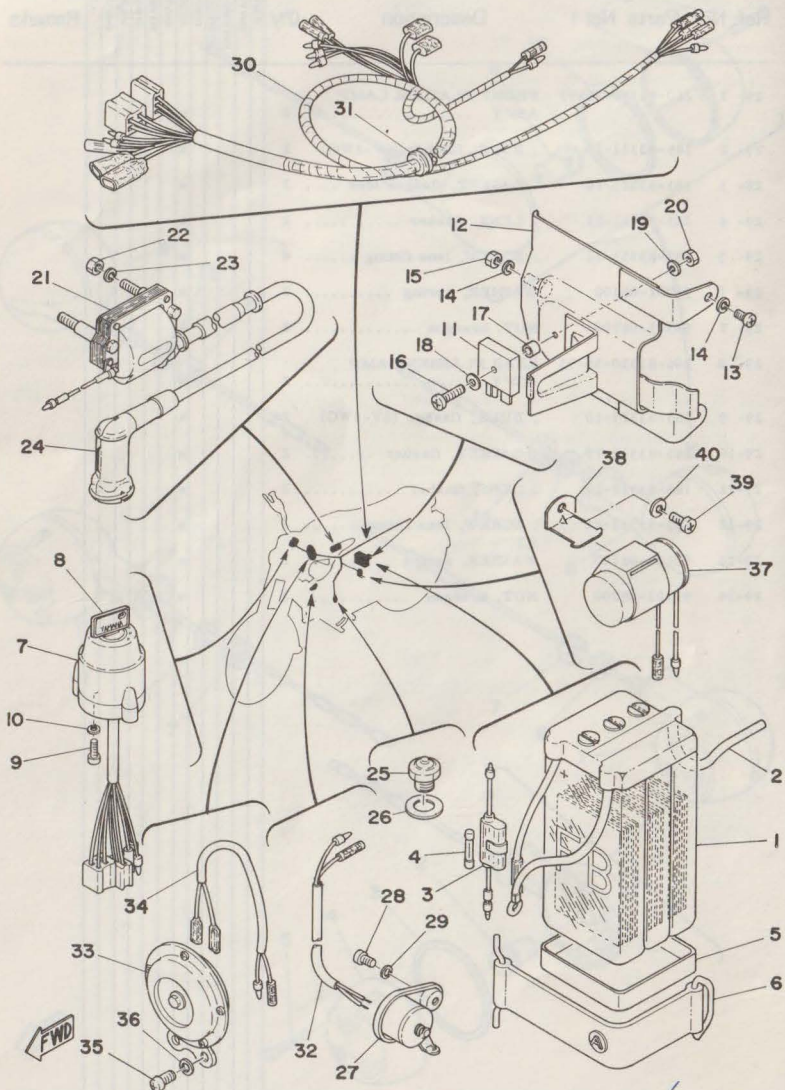

ELECTRICAL

Ref. No.	Parts No.	Description	Q'ty	FRANCE	HOLLAND	SWITZERLAND	W. GERMANY	GERMANY	BEELGIUM	SWEDEN	DENMARK	NORWAY	FINLAND	ENGLAND	ITALY	Remarks	
30- 1	104-82110-10	BATTERY ASS'Y	} U, R 1														
	104-82110-20	BATTERY ASS'Y															
	104-82110-30	BATTERY ASS'Y															
30- 2	90445-08171	HOSE (123-82112-00)	1			x				x							
30- 3	116-82150-00	FUSE HOLDER ASS'Y	1			x				x							
30- 4	116-82151-00	. FUSE (6V-10A)	2			x				x							
30- 5	104-82122-00	SEAT, battery	1			x				x							
30- 6	164-82131-00	BAND, battery	1			x				x							
30- 7	468-82508-45	MAIN SWITCH ASS'Y	1			x											
	471-82508-21	MAIN SWITCH ASS'Y	1							x							
30- 8	526-82579-00	. CAP, key	3			x											
30- 9	98501-05012	SCREW, panhead	2			x				x							
30-10	92901-05100	WASHER, spring	2			x				x							
30-11	353-81970-61	RECTIFIER ASS'Y	1			x				x							
30-12	220-81975-00	PLATE, rectifier fitting ...	1			x				x							
30-13	92501-06010	SCREW, panhead	2			x				x							
30-14	92901-06100	WASHER, spring	3			x				x							
30-15	95301-06600	NUT, hexagon	1			x				x							
30-16	98501-05025	SCREW, panhead	1			x				x							
30-17	355-81973-00	COLLAR, rectifier	1			x				x							
30-18	92901-05200	WASHER, plain	1			x				x							
30-19	92901-05100	WASHER, spring	1			x				x							
30-20	95301-05600	NUT, hexagon	1			x				x							
30-21	355-82310-40	IGNITION COIL ASS'Y	1			x				x							
30-22	95301-06600	NUT	2			x				x							
30-23	92901-06100	WASHER, spring	2			x				x							
30-24	808-82370-10	PLUG CAP ASS'Y	1			x				x							
30-25	136-82540-00	NEUTRAL SWITCH ASS'Y ...	1			x				x							

Fig. 30 ELECTRICAL

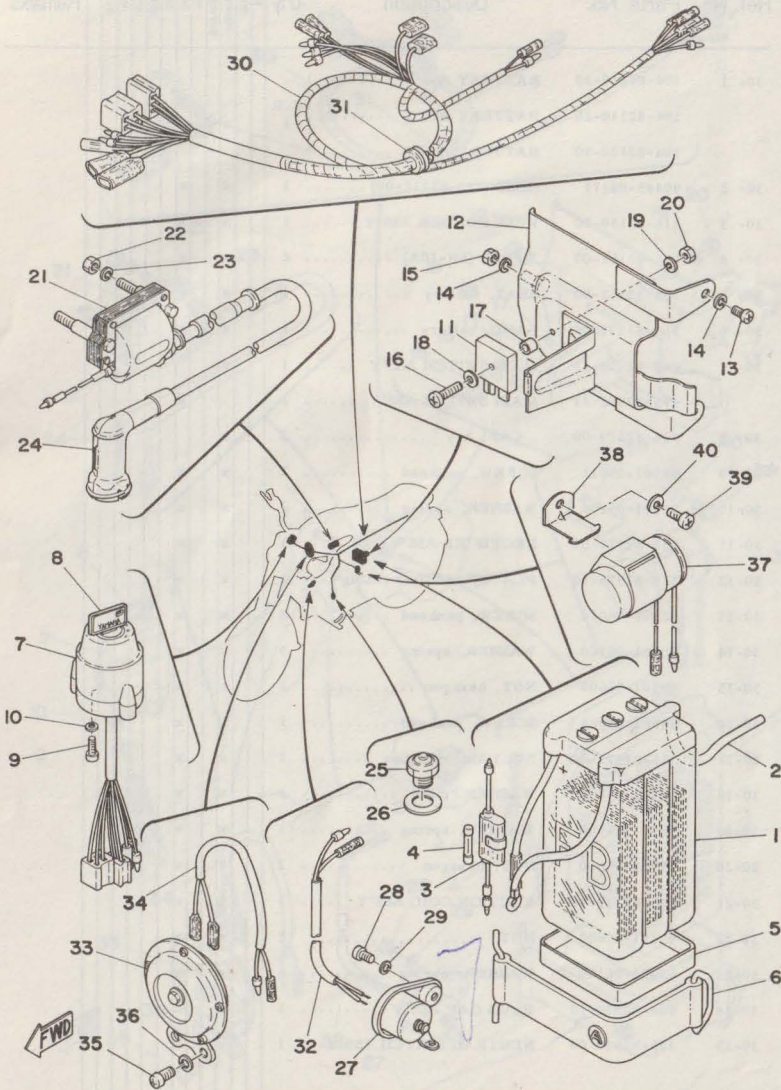

ELECTRICAL

Ref. No.	Parts No.	Description	Q'ty	FRANCE	GERMANY	ITALY	ENGLAND	AUSTRIA	NORWAY	SPAIN	NETHERLANDS	SWITZERLAND	USA	REMARKS
30-26	90430-11103	GASKET (102-82543-00) . . .	1	X	X									
30-27	122-82530-00	STOP SWITCH ASS'Y	1	X	X									
30-28	98501-05010	SCREW, panhead	1	X	X									
30-29	92901-05100	WASHER, spring	1	X	X									
30-30	469-82590-20	WIRE HARNESS ASS'Y	1	X										
	471-82590-20	WIRE HARNESS ASS'Y	1		X									
30-31	90480-13016	GROMMET (136-82598-00) . . .	1	X	X									
30-32	471-82531-00	WIRE, lead	1	X	X									
30-33	260-83371-12	HORN	1	X	X									
30-34	260-83373-00	READ, horn	1	X	X									
30-35	92501-06010	SCREW, panhead	2	X	X									
30-36	92901-06100	WASHER, spring	2	X	X									
30-37	375-83350-30	FLASHER RELAY ASS'Y	1	X										
	260-83350-10	FLASHER RELAY ASS'Y	1		X									
30-38	474-83352-00	BRACKET, flasher relay	1	X	X									
30-39	92501-06012	SCREW, panhead	1	X	X									
30-40	92901-06100	WASHER, spring	1	X	X									



Part No.	Part Name	Location	Qty.
14-22	WIRE HARNESS	FRONT	1
14-23	WIRE HARNESS	REAR	1
14-24	WIRE HARNESS	LEFT	1
14-25	WIRE HARNESS	RIGHT	1
14-26	WIRE HARNESS	UPPER	1
14-27	WIRE HARNESS	LOWER	1
14-28	WIRE HARNESS	MIDDLE	1
14-29	WIRE HARNESS	INNER	1
14-30	WIRE HARNESS	OUTER	1
14-31	WIRE HARNESS	INNER	1
14-32	WIRE HARNESS	OUTER	1
14-33	WIRE HARNESS	INNER	1
14-34	WIRE HARNESS	OUTER	1
14-35	WIRE HARNESS	INNER	1
14-36	WIRE HARNESS	OUTER	1
14-37	WIRE HARNESS	INNER	1
14-38	WIRE HARNESS	OUTER	1
14-39	WIRE HARNESS	INNER	1
14-40	WIRE HARNESS	OUTER	1
14-41	WIRE HARNESS	INNER	1
14-42	WIRE HARNESS	OUTER	1
14-43	WIRE HARNESS	INNER	1
14-44	WIRE HARNESS	OUTER	1
14-45	WIRE HARNESS	INNER	1
14-46	WIRE HARNESS	OUTER	1
14-47	WIRE HARNESS	INNER	1
14-48	WIRE HARNESS	OUTER	1
14-49	WIRE HARNESS	INNER	1
14-50	WIRE HARNESS	OUTER	1

NUMERICAL INDEX

Part No.	Part Name	Location	Qty.
14-51	WIRE HARNESS	INNER	1
14-52	WIRE HARNESS	OUTER	1
14-53	WIRE HARNESS	INNER	1
14-54	WIRE HARNESS	OUTER	1
14-55	WIRE HARNESS	INNER	1
14-56	WIRE HARNESS	OUTER	1
14-57	WIRE HARNESS	INNER	1
14-58	WIRE HARNESS	OUTER	1
14-59	WIRE HARNESS	INNER	1
14-60	WIRE HARNESS	OUTER	1
14-61	WIRE HARNESS	INNER	1
14-62	WIRE HARNESS	OUTER	1
14-63	WIRE HARNESS	INNER	1
14-64	WIRE HARNESS	OUTER	1
14-65	WIRE HARNESS	INNER	1
14-66	WIRE HARNESS	OUTER	1
14-67	WIRE HARNESS	INNER	1
14-68	WIRE HARNESS	OUTER	1
14-69	WIRE HARNESS	INNER	1
14-70	WIRE HARNESS	OUTER	1
14-71	WIRE HARNESS	INNER	1
14-72	WIRE HARNESS	OUTER	1
14-73	WIRE HARNESS	INNER	1
14-74	WIRE HARNESS	OUTER	1
14-75	WIRE HARNESS	INNER	1
14-76	WIRE HARNESS	OUTER	1
14-77	WIRE HARNESS	INNER	1
14-78	WIRE HARNESS	OUTER	1
14-79	WIRE HARNESS	INNER	1
14-80	WIRE HARNESS	OUTER	1
14-81	WIRE HARNESS	INNER	1
14-82	WIRE HARNESS	OUTER	1
14-83	WIRE HARNESS	INNER	1
14-84	WIRE HARNESS	OUTER	1
14-85	WIRE HARNESS	INNER	1
14-86	WIRE HARNESS	OUTER	1
14-87	WIRE HARNESS	INNER	1
14-88	WIRE HARNESS	OUTER	1
14-89	WIRE HARNESS	INNER	1
14-90	WIRE HARNESS	OUTER	1



NUMERICAL INDEX

NUMERICAL INDEX



Ref No.	Parts No.	Ref No.	Parts No.	Ref No.	Parts No.
3- 8	102-11633-01	22- 3	109-25197-90	15- 8	122-27413-00
14- 2	102-22123-00	19-29	109-26341-20	30-27	122-82530-00
20-11	102-24522-01	15- 5	109-27115-00	26- 2	122-83516-10
22- 8	102-25117-00	19-12	109-82820-11-94	27- 3	122-84523-30
22-26	102-25137-00	12-10	110-81346-21	10- 8	127-14123-00
23- 9	102-25315-00	12- 7	110-81346-21	10-25	127-14124-20
23- 8	102-25317-00	12- 4	110-81348-21	10-26	127-14124-20
23-15	102-25321-00-38	12- 9	116-81331-20	10-26	127-14124-23
23-43	102-25371-00	30- 3	116-82150-00	10-30	127-14125-00
23-32	102-25387-02	30- 4	116-82151-00	10-27	127-14133-00
23-30	102-25389-00	8-15	117-15644-00	10- 9	127-14134-00
23-25	102-25412-00	10-16	118-14116-02	10-13	127-14135-00
11-12	102-27114-00	1-19	120-15371-00	10-18	127-14137-00
12-12	104-81328-20	14-12	120-27430-02	10- 1	127-14141-10
30- 1	104-82110-10	14-13	120-27433-00	10- 1	127-14141-14
30- 1	104-82110-20	12- 6	120-81321-20	10- 2	127-14143-20
30- 1	104-82110-30	12- 9	120-81331-20	10- 2	127-14143-21
30- 5	104-82122-00	9- 3	122-14412-00	10- 2	127-14143-22
1-13	107-11181-01	11- 2	122-14612-02	10- 2	127-14143-30
1-11	109-11351-00	8- 2	122-15612-02	10- 2	127-14143-32
3- 7	109-11631-02-96	4- 3	122-16164-00	10- 2	127-14143-34
3- 7	109-11631-02-98	4-14	122-16164-00	10-24	127-14161-00
3- 7	109-11635-02	16- 4	122-21517-00	10-12	127-14171-00
3- 7	109-11636-02	13- 7	122-21724-00	23-37	127-25388-00
3- 7	109-11637-02	14- 6	122-22151-00	27- 5	127-84524-30
3- 7	109-11638-02	17-20	122-23346-01	2-23	129-15489-10
11-10	109-14713-00	18-13	122-23441-00	4- 5	131-16321-00
11-11	109-14714-02	20- 4	122-24181-00	11- 3	132-14613-00
14- 3	109-22141-00	20-12	122-24521-00	5-20	132-15653-00-10
17- 5	109-23125-00	20-13	122-24532-00	5-20	132-15653-00-12
17- 8	109-23143-00	20- 6	122-24610-01	5-20	132-15653-00-14
17- 7	109-23145-01	23- 0-1	122-25304-00	8-13	132-15664-00
22- 0-1	109-25104-00	23-14	122-25351-01	8-11	132-15676-00
22- 1	109-25111-00-35	23-16	122-25351-01	2- 3	132-16346-00
22-13	109-25121-01-35	23-19	122-25355-00	7-10	132-18113-01
22-12	109-25135-00	23- 2	122-25396-90	6-16	132-18140-01
22-23	109-25136-00	23- 3	122-25397-90	23- 1	132-25311-00-38
22-17	109-25155-00	23-28	122-25439-11	23-24	132-25366-01
22- 2	109-25196-90	15- 2	122-27112-00	19- 1	132-26111-01

NUMERICAL INDEX

Ref No.	Parts No.	Ref No.	Parts No.	Ref No.	Parts No.
19-29	132-26341-10	29- 3	183-83313-70	25- 1	241-84330-00-G6
18- 7	136-23415-00	29-10	183-83313-70	24- 1	241-84330-00-K7
19-17	136-26241-00	29- 4	183-83332-21	25- 1	241-84330-00-K7
30-25	136-82540-00	29-11	183-83332-21	24- 1	241-84330-00-M3
10-27	137-14133-00	29- 5	183-83333-21	25- 1	241-84330-00-M3
4-10	137-16356-00	29-12	183-83333-21	24- 1	241-84330-00-16
19-18	137-26242-60	18- 9	185-23435-00-98	25- 1	241-84330-00-16
19-20	137-26243-60	29- 2	185-83311-10	24- 1	241-84330-00-26
19-28	137-26331-11	29- 9	185-83311-10	25- 1	241-84330-00-26
19-28	137-26331-30	24- 3	195-84315-01	4-23	254-15631-00
19- 3	137-83912-02-38	24- 7	195-84324-00	1-14	257-11111-01-94
19- 5	137-83913-01	24- 8	195-84325-00	1-12	257-11311-00
19-15	137-83913-01	25-10	195-84325-00	3- 1	257-11412-01
19-13	137-83922-02-38	17-11	196-23191-40	3- 2	257-11422-00
19- 7	137-83941-01	21- 7	206-24830-00	3- 5	257-11681-00
13- 9	141-21717-00	29- 8	206-83330-35-93	10-17	257-14112-10
22-22	141-25138-00	17-17	207-23112-00	9- 1	257-14401-00-35
19-19	150-26249-00	17-15	207-23116-01	9- 8	257-14417-00
24- 2	150-84153-00	17- 9	207-23117-00	9- 2	257-14451-00
25- 2	150-84153-00	17- 4	207-23124-01	9- 6	257-14454-00
8- 6	156-15618-01	17- 4	207-23134-01	1- 1	257-15111-01
18- 2	156-23411-00	17-10	207-23141-00	5- 7	257-15389-00
18- 4	156-23412-00	17- 3	207-23147-00	2- 1	257-15410-01
2- 5	164-15415-00	17-14	207-23163-00	2-18	257-15413-00
6-12	164-18561-00	15- 1	207-27111-00	2-10	257-15417-01
18- 1	164-23462-00	12- 2	207-81312-20	2-24	257-15433-00
12-13	164-81246-21	12- 3	207-81313-21	2-19	257-15463-00
30- 6	164-82131-00	12-11	207-81315-20	8- 0-1	257-15610-02-91
12- 5	166-81332-20	13-11	209-21724-00	8- 1	257-15611-01
10-29	167-14119-00	17-13	209-23122-40	5-22	257-15651-01
10-28	167-14121-00	17-12	209-23142-40	8-18	257-15668-00
13-18	169-23480-10	17- 6	209-23150-41	3-13	257-16111-00
24-13	173-84313-00	21- 8	212-24832-00	4- 1	257-16150-01
25-15	173-84313-00	21- 9	212-24833-00	4- 0-1	257-16301-01
14- 7	180-22117-00	27-11	214-84553-01	4- 6	257-16324-00
15-11	180-27231-01	14- 1	220-22110-00-33	4-20	257-16341-00
18- 6	183-23411-00	30-12	220-81975-00	4-17	257-16342-00
18- 5	183-23412-00	26- 4	237-83523-00	4- 7	257-16351-00
19- 1	183-26111-20	24- 1	241-84330-00-G6	4-16	257-16357-00

NUMERICAL INDEX

Ref No.	Parts No.	Ref No.	Parts No.	Ref No.	Parts No.
4- 4	257-16371-00	10- 6	260-14181-00	9- 7	283-14453-00
5- 4	257-17121-00	10- 4	260-14184-00	13-14	283-21717-00
5- 2	257-17131-01	10- 3	260-14185-00	23-28	283-25444-10
5- 5	257-17141-00	10-11	260-14190-12	19- 1	283-26111-00
5-17	257-17211-00	16- 1	260-21510-00-93	2-21	288-14481-01
5-18	257-17219-00	14- 8	260-22311-00-35	25- 3	290-84115-21
5-14	257-17221-01	17- 0-1	260-23101-31-35	25- 8	290-84124-21
5-16	257-17231-00	17-18	260-23111-40	10-19	296-14136-00
5-12	257-17241-00	17-22	260-23121-40-G6	11- 5	296-14753-02
5- 1	257-17411-01	17-22	260-23121-40-K7	15-11	296-27231-00
5-11	257-17421-01	17-22	260-23121-40-M3	12- 8	296-81325-20
5-28	257-17461-10	17-22	260-23121-40-16	23-14	304-25364-00
5-28	257-17461-20	17-22	260-23121-40-26	8-16	305-15641-00
5-28	257-17461-30	17- 1	260-23126-40-35	8- 8	305-15660-02
5- 9	257-17471-01	17-23	260-23131-40-G6	17-16	307-23114-00
7- 1	257-18101-01	17-23	260-23131-40-K7	25- 7	308-84135-21
7- 9	257-18111-00-91	17-23	260-23131-40-M3	9-16	314-13613-00
6- 3	257-18512-01	17-23	260-23131-40-16	9-15	314-13616-01
6-19	257-18531-00	17-23	260-23131-40-26	2-17	315-15362-01
6- 1	257-18534-00	17- 2	260-23136-40-35	22-15	326-25330-10
6- 7	257-18541-61	17-21	260-23318-40	23-17	326-25330-10
15- 3	257-27211-00	17-19	260-23340-40-33	5-28	347-17451-90
12- 0-1	257-81300-22	19-28	260-26331-00	10-16	348-14116-03
12- 1	257-81350-22	19-27	260-26335-00	11- 1	348-14611-00
6- 2	259-18511-01	19-27	260-26335-10	11- 5	348-14753-00
3-10	260-11601-00	19-27	260-26335-20	12- 5	353-81332-20
3-10	260-11601-10	19-29	260-26341-00	30-11	353-81970-61
3-10	260-11601-20	15- 7	260-27411-00	3- 0-1	355-11400-00
3-10	260-11601-30	13-17	260-28100-10	20-10	355-24515-00
3-10	260-11601-40	29- 1	260-83310-35-93	20-15	355-24523-00
3- 0-2	260-11630-00	30-37	260-83350-10	30-17	355-81973-00
3- 0-2	260-11630-10	30-33	260-83371-12	30-21	355-82310-40
3- 0-2	260-11630-20	30-34	260-83373-00	23-29	357-25381-00
3- 0-2	260-11630-30	26- 1	260-83510-11	20- 9	367-24500-02
3- 0-2	260-11630-40	26- 3	260-83520-11	30-37	375-83350-30
10-14	260-14114-00	26- 8	260-83550-00	27- 4	375-84521-40
10-20	260-14131-00	27- 2	260-84514-40	1-12	378-11311-60
10-10	260-14142-25	10-17	283-14112-25	9-14	378-13610-61
10-21	260-14158-01	10-14	283-14114-00	9-19	378-13621-60

NUMERICAL INDEX

Ref No.	Parts No.	Ref No.	Parts No.	Ref No.	Parts No.
11- 4	378-14710-20	14-15	467-22210-40-G6	16- 5	471-21610-10-93
1- 2	378-15121-60	14-15	467-22210-40-K7	16-11	471-21623-00
1-22	378-15359-60	14-15	467-22210-40-M3	21- 6	471-24770-00-G6
2-11	378-15426-60	14-15	467-22210-40-16	21- 6	471-24770-00-K7
2-12	378-15451-60	14-15	467-22210-40-26	21- 6	471-24770-00-M3
1-13	381-11181-60	20- 1	467-24110-00-01	21- 6	471-24770-00-16
11- 4	381-14710-00	20- 1	467-24110-00-02	21- 6	471-24770-00-26
12- 0-1	381-81300-20	20- 1	467-24110-00-05	21- 6-1	471-24771-00
12- 3	381-81313-20	20- 1	467-24110-00-06	30- 7	471-82508-21
12-11	381-81315-20	20- 1	467-24110-00-07	30-32	471-82531-00
12- 1	381-81350-20	20- 5	467-24184-00	30-30	471-82590-20
19- 2	381-82710-00	20- 2	467-24244-00	27-21	471-84517-01
19- 2	381-82710-20	20- 3	467-24245-00	14- 1	474-22110-00-33
25- 0-1	381-84103-91	26- 5	467-83519-00-98	23- 0-1	474-25304-40
25- 6	381-84112-91	13- 1	468-21110-40-33	23- 2	474-25396-90
25- 5	381-84114-90	16- 5	468-21610-40-93	23- 3	474-25397-90
25- 4	381-84120-91	14-15	468-22210-41-G6	30-38	474-83352-00
25- 9	381-84154-90	14-15	468-22210-41-K7	3- 3	517-11651-00
13-10	394-21721-00-G6	14-15	468-22210-41-M3	16-10	526-21621-00
13-10	394-21721-00-K7	14-15	468-22210-41-16	30- 8	526-82579-00
13-10	394-21721-00-M3	14-15	468-22210-41-26	20-14	603-24531-01
13-10	394-21721-00-16	14- 8	468-22311-40-35	30-24	808-82370-10
13-10	394-21721-00-26	21- 1	468-24730-00	14-16	90101-10255
19-25	394-26311-00	21- 1-1	468-24731-00	14-16	90101-12090
19-25	394-26311-10	30- 7	468-82508-45	13- 2	90105-08025
19-25	394-26311-20	19- 2	468-82710-01-94	18-10	90105-10006
19-32	407-26290-50	24- 0-1	468-84103-40	6-17	90109-06001
19-33	407-26290-60	24- 6	468-84112-40	23-26	90109-08057
27- 6	420-84551-40-35	24- 5	468-84114-40	23-44	90109-08183
12- 6	437-81321-20	24- 4	468-84120-40	4-22	90113-06009
22-28	451-25181-01	27- 0-1	468-84510-40	1-10	90116-06026
18-12	462-23442-00	27- 1	468-84511-40	19-30	90123-06011
13-19	467-21308-00	30-30	469-82590-20	4- 8	90149-05057
13- 6	467-21711-00-G6	9-20	470-13555-60	7- 4	90149-08094
13- 6	467-21711-00-K7	10- 0-1	470-14101-00	23-27	90170-08157
13- 6	467-21711-00-M3	10- 0-1	471-14101-00	3-15	90170-12060
13- 6	467-21711-00-16	2-11	471-15420-60	4-11	90170-12060
13- 6	467-21711-00-26	13- 1	471-21110-00-33	3-20	90170-12175
13-15	467-21786-00	16- 1	471-21510-00-93	23-38	90170-18165
13-16	467-21787-00				

NUMERICAL INDEX

Ref No.	Parts No.	Ref No.	Parts No.	Ref No.	Parts No.
22-31	90171-10004	19-11	90338-07011	15- 6	90506-29054
23-39	90171-10004	6-15	90338-26008	8-12	90508-26136
1-15	90176-06002	1-17	90340-12005	7- 3	90508-32207
14-21	90176-10013	1-18	90340-12038	4-13	90560-17150
14-21	90176-10013	27-12	90387-06241	18-14	91214-06035
13- 8	90179-06034	27-18	90387-07390	10-15	91401-12010
13-12	90179-06036	22-29	90387-10081	15-13	91401-20012
19-31	90179-06143	23-31	90387-12412	23-50	91401-20012
15-17	90179-06176	5-13	90387-16127	22-32	91401-20020
5-30	90179-12015	5-26	90387-17137	23-53	91401-20020
5-30	90179-12016	5-26	90387-17138	13-13	91401-50075
18- 8	90179-25051	3-12	90387-17139	2- 4	91810-02015
22-19	90185-06034	23-36	90387-18143	2-13	91810-02015
23-21	90185-06034	30-26	90430-11103	1- 3	91810-05016
27-13	90201-06059	10-33	90445-05013	19-22	92501-06008
22-30	90201-10123	10-32	90445-05015	30-13	92501-06010
14-19	90201-10140	30- 2	90445-08171	30-35	92501-06010
14-19	90201-10140	20- 7	90445-09114	5-10	92501-06012
14-17	90201-12175	1-20	90446-07009	16-12	92501-06012
3-18	90201-12178	19-21	90462-06009	30-39	92501-06012
7- 7	90201-12183	20- 8	90467-08003	1-23	92501-06015
14-18	90201-12190	26- 7	90468-10050	9-21	92501-06015
5-23	90201-13202	23-48	90468-12007	9-22	92501-06015
4- 2	90201-23315	8-17	90468-26048	2-20	92501-06018
5-21	90206-15021	2-16	90480-12012	10- 7	92501-06018
3-14	90208-12015	27-22	90480-12013	1- 4	92501-06030
4-12	90208-12015	30-31	90480-13016	2-14	92501-06030
26- 6	90209-05029	27-19	90480-14102	2- 8	92501-06040
27-17	90209-06095	15-15	90501-10245	2-15	92501-06040
18-11	90209-10021	4- 9	90501-20122	2- 7	92501-06045
8- 4	90209-10108	23-45	90501-20129	1- 5	92501-06045
19-10	90209-10131	8- 3	90504-18005	1- 6	92501-06050
5-29	90215-13019	2-22	90506-06095	2- 9	92501-06050
5-29	90215-13025	2- 2	90506-07006	1- 9	92501-06055
6-10	90249-04039	7- 2	90506-09009	1- 7	92501-06060
15-16	90249-12008	6-18	90506-09112	1- 8	92501-06065
6- 4	90250-06013	22-16	90506-16034	13-20	92701-06030
3-21	90280-03017	23-18	90506-16034	9-18	92901-03100
6- 6	90334-10006	15-12	90506-20041	10-22	92901-04100

NUMERICAL INDEX

Ref No.	Parts No.	Ref No.	Parts No.	Ref No.	Parts No.
12-14	92901-04100	29- 6	92901-08100	5-24	93410-13004
6-14	92901-05100	29-13	92901-08100	8-10	93410-15005
11- 7	92901-05100	21- 3	92901-08200	8-14	93410-25017
14-11	92901-05100	21-11	92901-08200	23-34	93420-42007
30-10	92901-05100	21- 4	92901-08600	6-11	93430-03014
30-19	92901-05100	23-49	92901-08600	6- 5	93430-08006
30-29	92901-05100	14- 5	92901-10100	7- 8	93430-10016
27-24	92901-05200	18-17	92901-10100	15- 4	93430-12008
30-18	92901-05200	14-17	92901-10200	8- 5	93440-10028
18-15	92901-06100	18-18	92901-10600	5- 3	93440-16030
19-23	92901-06100	3-19	92901-12100	5-15	93440-16030
22-20	92901-06100	24-10	92903-08200	6- 8	93440-32017
23-22	92901-06100	25-12	92903-08200	3- 9	93450-13022
23-41	92901-06100	7- 6	93101-12004	4-19	93501-04011
27- 8	92901-06100	3-17	93102-20009	18- 3	93501-04011
27-14	92901-06100	5-27	93102-25017	4-15	93503-16003
30-14	92901-06100	1-21	93103-25078	6- 9	93604-22050
30-23	92901-06100	22-24	93104-07003	6-20	93605-20043
30-36	92901-06100	23-11	93104-21016	22-27	93700-06001
30-40	92901-06100	22-10	93106-20001	22- 5	94122-17008
1-16	92901-06200	23-35	93106-30004	23- 5	94125-17012
16-13	92901-06200	22-11	93107-42001	22- 5	94125-17141
23-42	92901-06200	4-18	93108-15001	23- 5	94127-17137
27- 9	92901-06200	8- 9	93109-15001	22- 6	94222-17003
15-14	92901-06600	22-25	93210-14104	22- 6	94225-17005
16- 9	92901-06600	23-13	93210-41041	23- 6	94225-17005
19- 9	92901-06600	10- 5	93220-08002	23- 6	94227-17032
19-24	92901-06600	23-33	93306-00406	22- 7	94326-17019
22-21	92901-06600	22- 9	93306-20204	22- 7	94330-17023
23-23	92901-06600	5- 8	93306-20303	23- 7	94330-17023
9-13	92901-08100	3-16	93306-20414	22- 4	94412-17002
11- 9	92901-08100	23-10	93306-30101	23- 4	94414-17003
13- 5	92901-08100	23-12	93306-30103	22- 4	94416-17096
15-10	92901-08100	3-11	93306-30302	23- 4	94418-17109
16- 3	92901-08100	5-25	93306-30305	23-51	94504-20093
16- 7	92901-08100	3- 6	93310-11268	23-51	94504-20101
23-47	92901-08100	3- 4	93310-41810	23-52	94604-20001
24-11	92901-08100	5- 6	93410-13004	1-24	94701-00039
25-13	92901-08100	5-19	93410-13004	10-31	95301-05600

NUMERICAL INDEX

Ref No.	Parts No.	Ref No.	Parts No.	Ref No.	Parts No.
11- 6	95301-05600	16- 2	97301-08012		
27-23	95301-05600	15- 9	97301-08015		
30-20	95301-05600	16- 6	97301-08015		
16-14	95301-06600	21- 2	97301-08015		
22-19	95301-06600	21-10	97301-08015		
23-21	95301-06600	28-17	97303-06030		
23-40	95301-06600	24- 9	97303-08018		
27-15	95301-06600	25-11	97303-08018		
30-15	95301-06600	8- 7	97311-06025		
30-22	95301-06600	16- 8	97321-06015		
4-21	95301-06700	7-11	97321-06020		
27- 7	95301-06800	19- 8	97323-06008		
7- 5	95301-08600	2- 6	98501-04006		
11- 8	95301-08600	9- 9	98501-04008		
21- 5	95301-08600	14- 9	98501-05008		
23-46	95301-08700	10-23	98501-04010		
24-12	95301-08700	30-28	98501-05010		
25-14	95301-08700	6-13	98501-05012		
29- 7	95301-08700	30- 9	98501-05012		
29-14	95301-08700	14-10	98501-05020		
14- 4	95301-10600	19- 4	98503-05020		
18-16	95301-10600	19-14	98503-05020		
19-26	95301-10700	30-16	98501-05025		
14-14	95301-12700	9-17	98512-03008		
9- 5	95303-06800	12-15	98701-05015		
27-20	95303-06800				
14-20	95304-12800				
19- 6	95601-05100				
19-16	95601-05100				
9-12	95701-08100				
13- 4	95701-08100				
9-11	95821-08080				
9-10	95821-08100				
13- 3	95821-08120				
27-10	97301-06020				
27-16	97301-06020				
22-18	97301-06030				
23-20	97301-06030				
9- 4	97301-06187				